

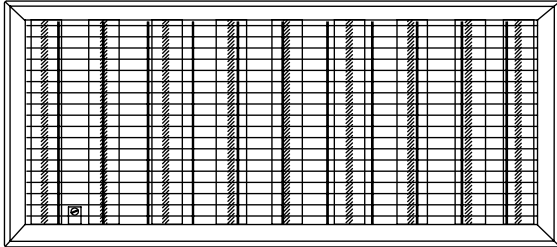

1550 Series Floor Register



Standard:

- Heavy duty honeycomb construction
- Blades run parallel to longest dimension given
- Positive Volume set screw
- Recessed screwdriver operated opposed blade damper to control air volume for positive balance of system
- Driftwood Tan

Optional:

- ☐ Mounting holes for sidewall and ceiling application
- ☐ Reinforced welded core and extra support for heavy duty application (1550 R)

Finishes:

- ☐ Soft White

Designer Colors:

- ☐ Navajo White
- ☐ Forest Green
- ☐ Burgundy
- ☐ Camaro Silver
- ☐ Bronze

- ☐ Royal Blue
- ☐ Coffee Tan
- ☐ Almond
- ☐ Black velvet
- ☐ Vanilla

Custom Plating:

- ☐ Polished Brass
- ☐ Antique Brass
- ☐ Polished Chrome
- ☐ Copper
- ☐ Pewter
- ☐ Satin Nickle

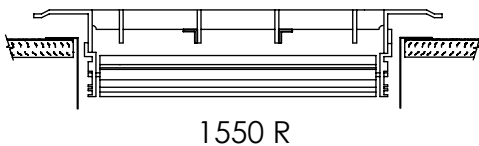
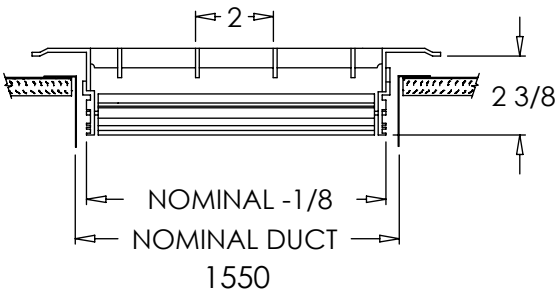
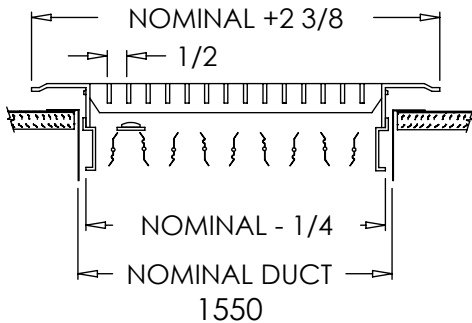

PROJECT

LOCATION

ENGINEER

ARCHITECT

CONTRACTOR

SUBMITTAL REVIEW