

OWNERS MANUAL

Top Mount Toilet Seat



INSTALLATION INSTRUCTIONS

Thank you for selecting American Standard – the benchmark of fine quality for over 150 years. To ensure this product is installed properly, please read these instructions carefully before you begin. Certain installations may require professional help.

INSTALLATION PREPARATION

- Please unpack carefully and identify all parts needed for installation by using the Box Contents page as a reference. Inspect the product and report any damages or missing parts immediately to customer care by calling 855-815-0004. Follow the prompts for consumer/bathing. Local building codes vary by location. Observe all local plumbing and building codes.

NOTE: Take extra care in handling the seat surfaces. Use only non-abrasive cloths to avoid scratching.

- Wear protective equipment during installation to avoid injury.
- Please keep these instructions for after care and customer service details.

Image shown may vary from product purchased.

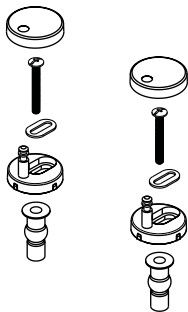

TOP MOUNT
STEPS 1a - 10a

TOP MOUNT

1a

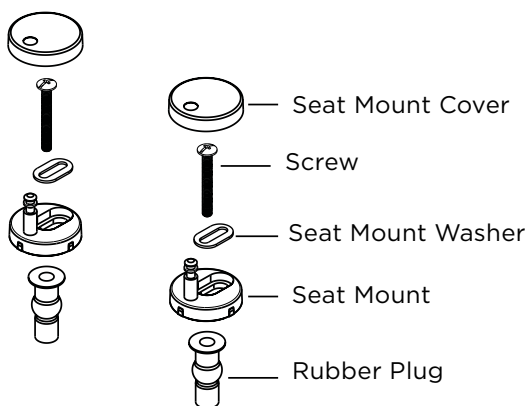

2a

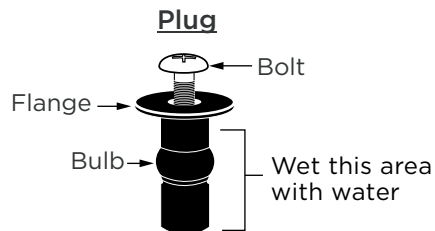

For ease of installation of black rubber plugs, insert steel bolt (capture a few threads), and wet the lower area with some water (soapy water works best).

3a

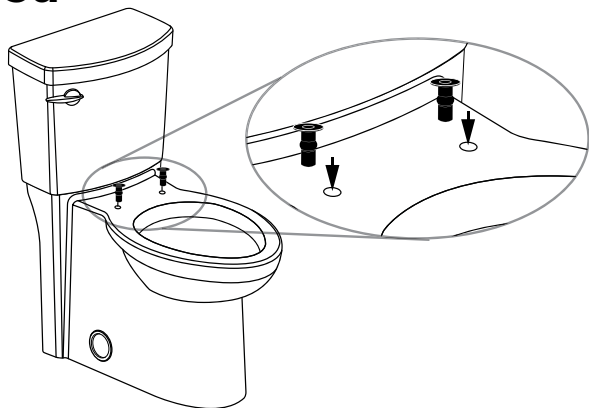

4a

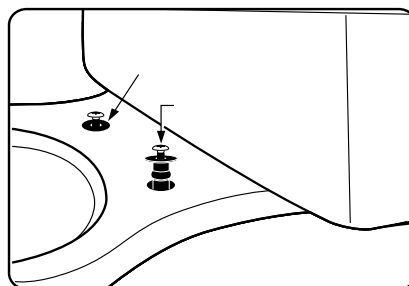

**NOTE: FLANGE MUST REMAIN ABOVE THE SURFACE.
DO NOT ALLOW PLUG TO FALL THROUGH!**

5a

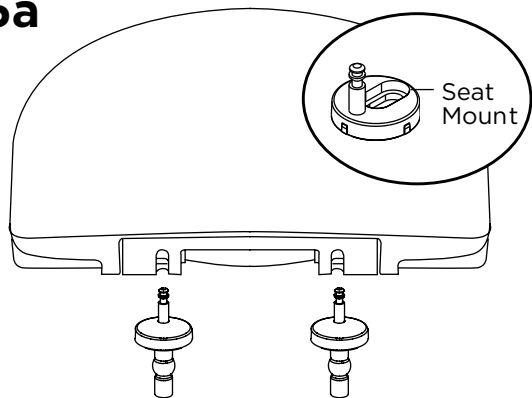

Snap Seat Mount into holes on the bottom of the seat.

6a

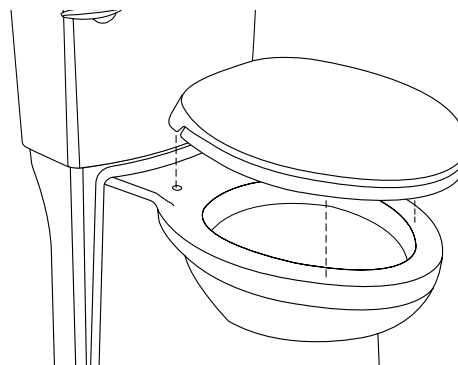

Place seat with Seat Mount onto bowl.
Align seat with front of bowl.

TOP MOUNT

7a

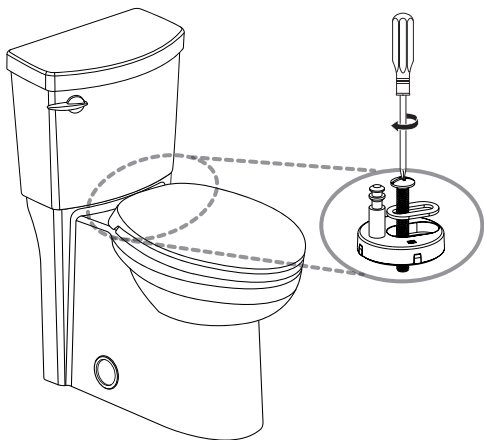

Put screws and seat mount washers into seat mount and securely tighten using a screwdriver.

8a

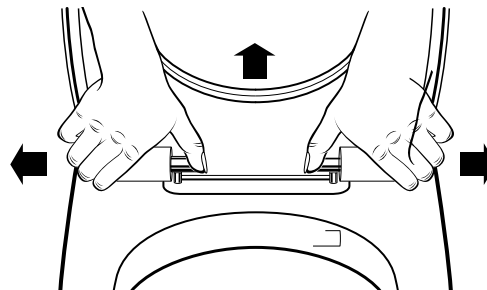

Open the seat and cover. Push both inside buttons to release seat and cover. Pull the seat and cover upwards to take it off the seat mounts.

9a

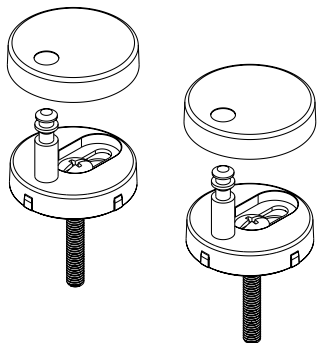

Place seat mount cover over seat mounts.

10a

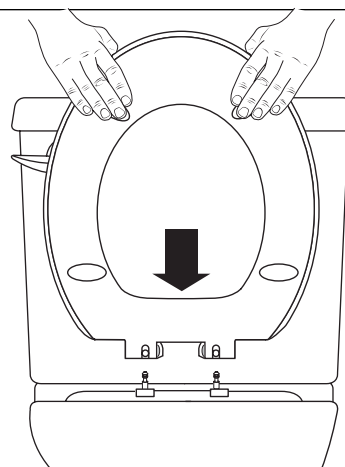

Place seat back on bowl and click seat onto seat mounts.