

# INSTALLATION INSTRUCTIONS CARE AND MAINTENANCE

*American  
Standard*

## STAINLESS STEEL SINKS

### Drop-In Sinks & Undercounter Mounting Sinks

Thank you for selecting American Standard - the benchmark of fine quality for over 100 years. To ensure this product is installed properly, please read these instructions carefully before you begin. (Certain installations may require professional help.) Also be sure your installation conforms to local codes.

**⚠ CAUTION: PRODUCT IS FRAGILE. TO AVOID BREAKAGE AND POSSIBLE INJURY HANDLE WITH CARE!**  
NOTE: Pictures may not exactly define contour of china and components.

Before installing the sink, inspect it for damage. DO NOT install a damaged unit.  
Notify your American Standard distributor of any damage. Replace sink in its original packing.

### OBSERVE LOCAL PLUMBING AND BUILDING CODES

#### Recommended Tools & Materials

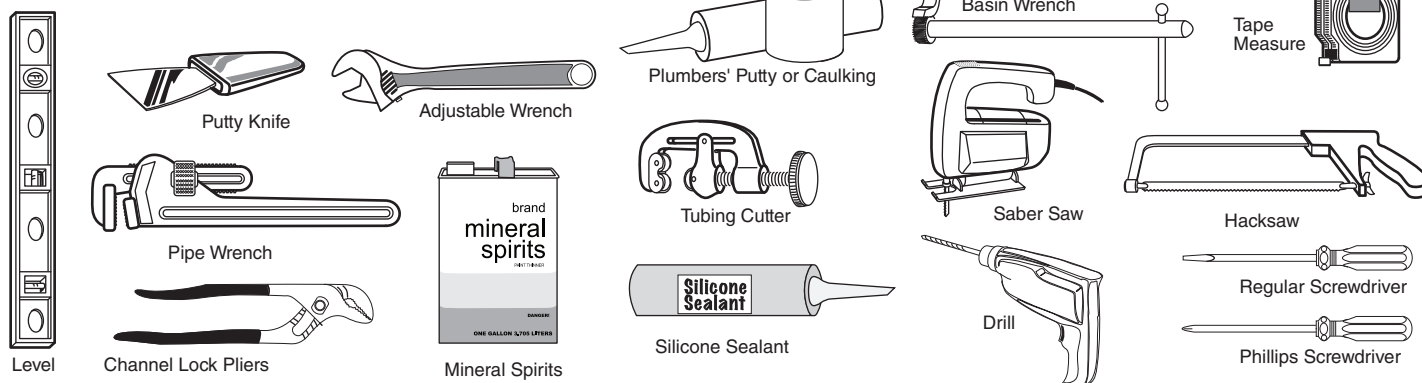

#### MAINTENANCE FOR STAINLESS STEEL SINKS:

To keep the original quality of your Stainless Steel Sink, we recommend regular cleaning. Use a mild liquid dish detergent and water to clean the product after use. Rinse carefully and dry.

#### PLEASE HAVE THE FOLLOWING IN MIND:

- Do not let water or other liquids dry on the product. Liquids that are left to dry leave a grey build-up stain on the steel.
- Stainless steel can stand hard treatment, but sharp objects can easily scratch the surface. These scratches are more visible when the product is new. After a period of use these marks will be smoothed out without the product losing its luster.
- Never use scouring powder or steel wool to clean the surface. Apart from the risk of scratches, there is also a risk that rust stains will attack the steel.
- Avoid Chlorine-based solutions from coming into contact with the stainless steel.
- Silver polish leaves spots that cannot be removed.
- Acidic foods (e.g. juices, salt, mustard, mayonnaise, etc.) must be cleaned up immediately.

#### DISCOLORATION

More stubborn spots are often caused by impurities in the water or household substances. These can be removed with special polish agents for stainless steel. Dull spots can become lustrous again if rubbed with chalk on a soft cloth.

USE  
FOR  
FUTURE  
SAVE

## FOR DROP-IN SINK INSTALLATION

### 1 PREPARING THE COUNTERTOP

Make sure there are no obstructions such as cabinets, plumbing, etc. below or above the countertop.

Place template on countertop checking to make sure the sink will line up correctly with plumbing.

**NOTE:** If not using a template, turn sink upside down on counter top and trace a line of the outer rim using a pencil. Remove the sink from the counter top and draw a cutout line 5/16" (8mm) inside the original rim outside line with 1-1/2" (38mm) radius corners.

To begin the cutout for the sink, drill a hole then use a sabersaw to carefully cut along the template or pencil line.

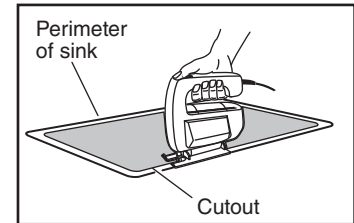
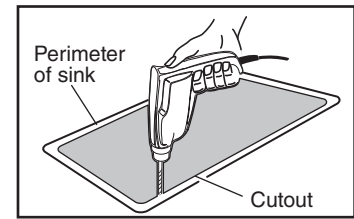

### 2 CHECK CUTOUT DIMENSIONS

Check the countertop cutout opening by placing the sink in the opening to be sure it is sized properly. The rim of the sink must be set uniformly on the countertop to ensure the corners of the sink seat properly. If the sink does not fit adjust the cutout opening using the saber saw.

### 3 PREPARING THE STRAINER AND FAUCET ASSEMBLY

**NOTE:** Your sink may not come with the strainer and faucet assembly in which case you will need to purchase separately and follow instructions included with the purchased products.

Install the strainer as shown.

Install the faucet following the instructions included with the faucet.

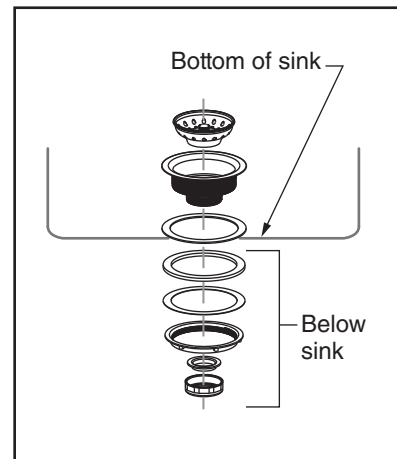

### 4

Apply a generous portion of sealant inside line traced on countertop.

5

Assemble the screw with the clamp as shown (1).

Slide the screw and clamp assembly under the open end of the U Channel as the location on the template suggests.

Turn the clamp in the same direction as the U Channel and hand tighten the screw as shown (2).

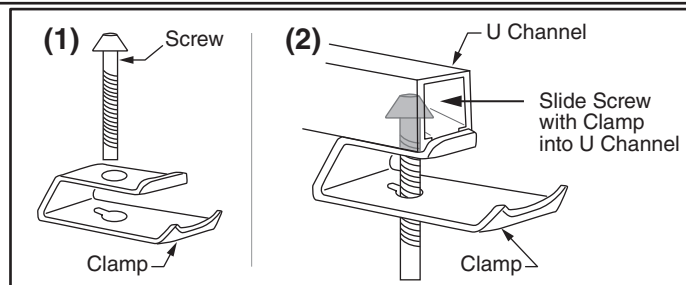

#### For Sinks with Mounting Brackets Attached to Sink

Place notched end of the screw into the keyhole slot in sink bracket. Use one screw per double bracket. Turn clamp to rest against side of sink.

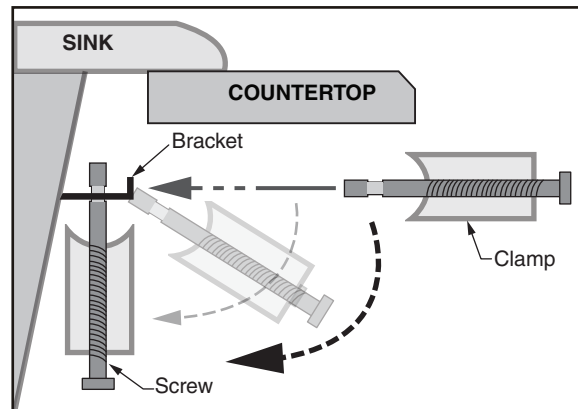

6

A. Carefully lower sink into cutout. Make sure the sink is in the proper location and press down firmly.

**WARNING:** Improper tightening of screws could result in improper installation or cause damage to the sink.

B. Loosen the screw and turn the clamp 90 degrees so the clamp can catch the bottom of countertop as shown. Hand tighten the screws.

C. Recheck sink position on countertop. Tighten all screws an additional 1/4 turn with a flat head screwdriver.

**WARNING: DO NOT OVERTIGHTEN**

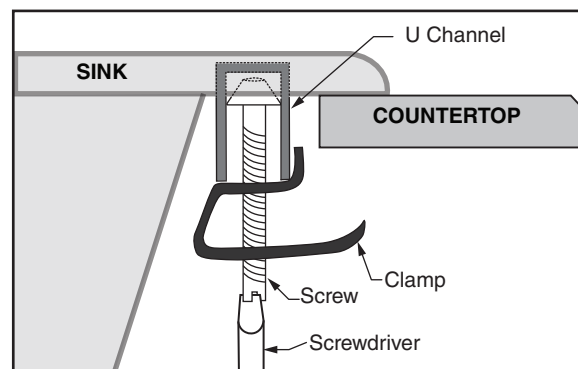

#### For Sinks with Mounting Brackets Attached to Sink

Turn the clamp 90 degrees so they grasp the underside of the countertop. Tighten the clamps gradually, only until sink rim is flush with countertop. Do not over tighten as damage can result.

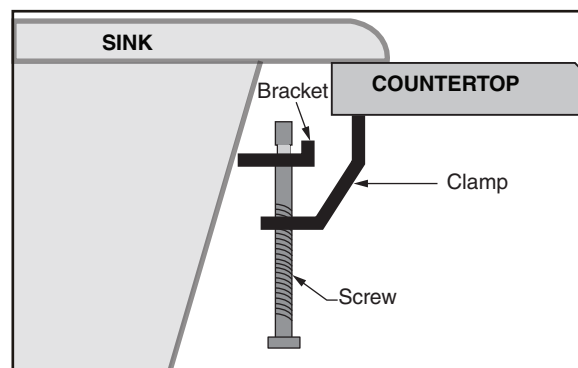

7

Connect supply lines to faucet finger tight, and carefully bend to engage with the supply stops. Tighten connections to faucet for secure seal.

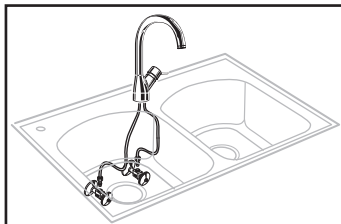

8

Connect drain assembly hand tight to check alignment. It may be necessary to cut off part of the tailpiece (area "A") or part of the horizontal leg of the trap (area "B").

Secure joint for watertight assembly.

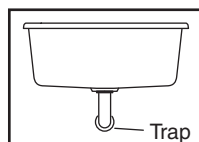

Single Bowl

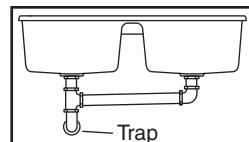

Double Bowl

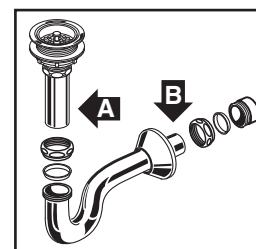

## FOR UNDERCOUNTER MOUNTING SINK INSTALLATION

### BEFORE YOU BEGIN...

Unpack new sink and inspect carefully for damage. Notify your American Standard distributor of any damage. Replace the sink in its original packing carton to protect it until you are ready to begin installation.

### CAUTION

**Strongly Recommend For Professional Installers to Perform Installation.**

- Locate sink to be installed. Provide proper clearance under the countertop for the faucet supply lines and the structural parts of your cabinet. **NOTE:** Some templates share the drop-in and undercounter mounting. Make sure you used the undercounter mounting portion of the template.
- Cut the inner portion from the supplied template and discard.
- Attach the outer portion of the template to the countertop using masking tape. Be sure there is enough clearance for the faucet and supply line. If the template has a hole for the faucet, use 1-3/8" (35 mm) diameter hole saw to cut hole on the countertop.

**1**

Drill a clearance hole inside the cutout line.

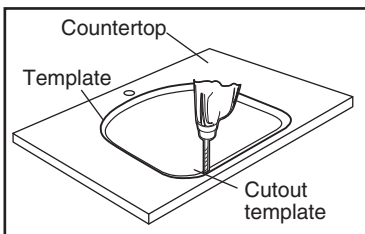

**2**

Cut opening on cut line of the template.

**NOTE:** Contact your countertop distributor for the best method of cutting materials such as marble, hard synthetics, etc.

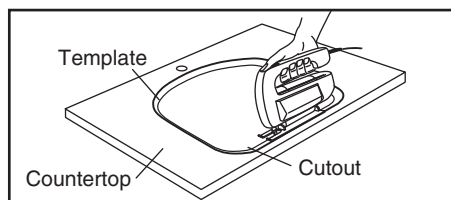

**3**

The mounting kit is supplied with each sink. It includes the brackets, inserts and fasteners. Consult your countertop supplier to use the proper inserts and fasteners depend on the type of countertop material.

Locate and drill the mounting hole for insert (following with countertop supplier's suggestion) as shown below. The mounting hole should allow even spacing of mounting brackets around the sink.

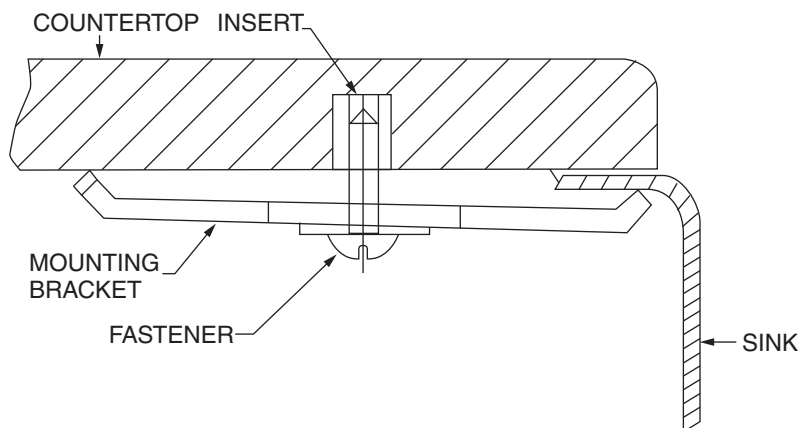

4

Apply sealant to the rim of the sink near the inside edge.  
Be careful not to miss or skip an area.

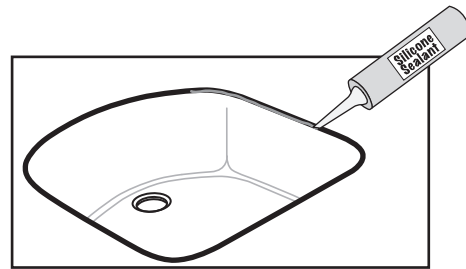

5

Lift the sink into place. Follow the instructions from your countertop supplier in order to tighten the mounting hardware evenly.

**⚠ DO NOT OVERTIGHTEN**

6

Apply silicone sealant.

Wipe away any excess sealant. Fill voids and allow to cure.

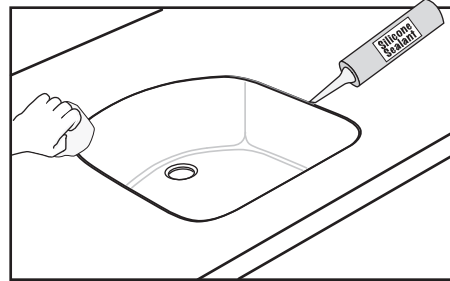

7

Mount the faucet and strainer assembly following the manufacturer's instructions.

**NOTE:** Your sink may not come with the strainer and faucet assembly in which case you will need to purchase separately and follow instructions included with the purchased products.

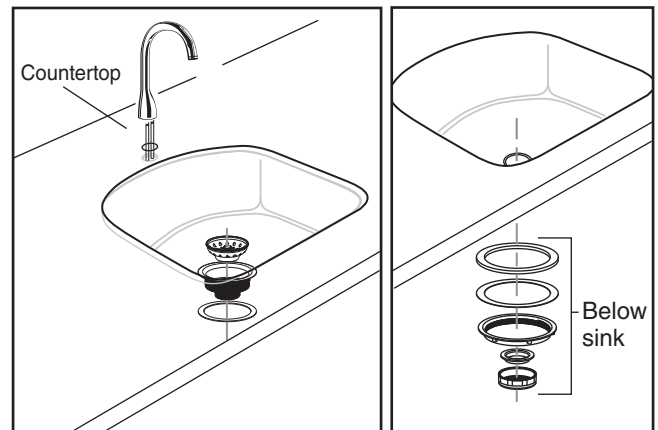

8

Connect supply lines to faucet finger tight, and carefully bend to engage with the supply stops. Tighten connections to faucet for secure seal.

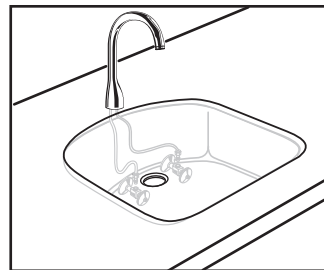

9

Connect drain assembly hand tight to check alignment. It may be necessary to cut off part of the tailpiece (area "A") or part of the horizontal leg of the trap (area "B").

Secure joint for watertight assembly.

