



Buy it for looks. Buy it for life.®

Illustrated Parts

■ **Order by Part Number**

*There is more than 1 version of this model.
Page down to identify the version you have.*

• 2nd generation valve manufactured on and after September 3rd, 2009. Can be identified by the check stop nut (smaller drive feature).

• 147208 Thermostatic cartridge will not work in 1st generation valves.

**ExactTemp®
3/4" Thermostatic Valve**

MODEL
S3371

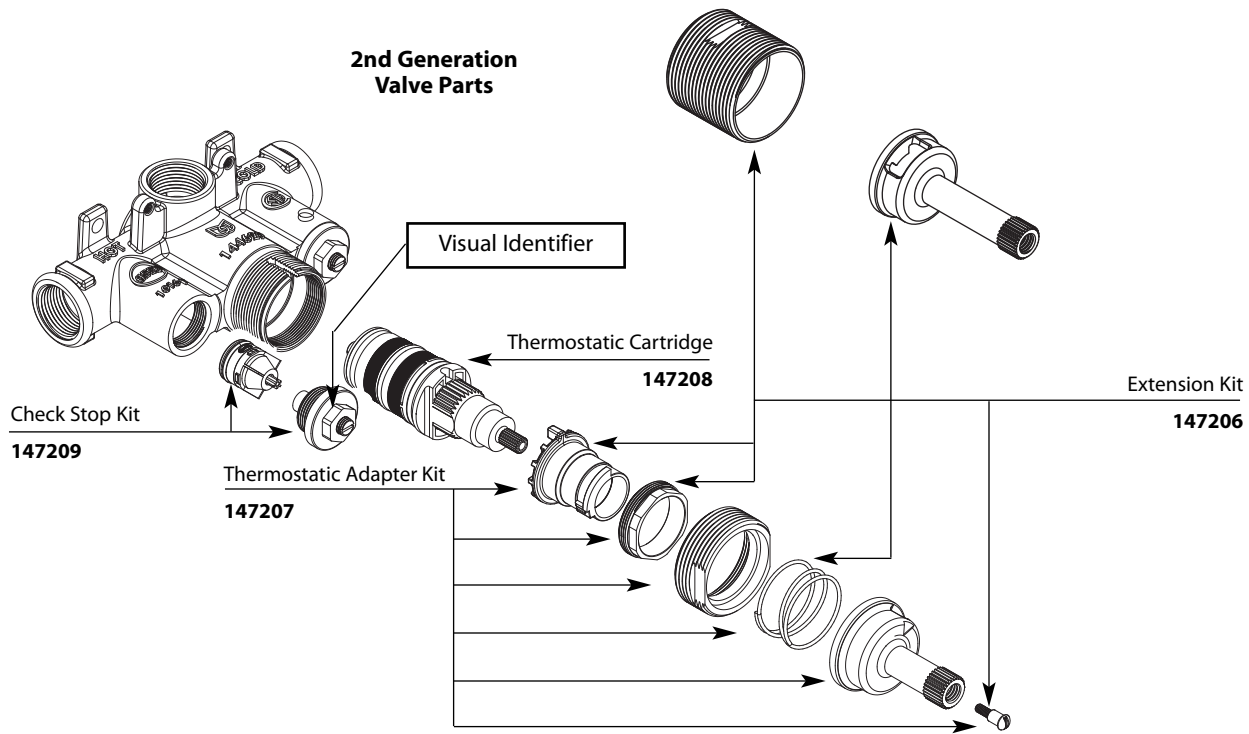



Buy it for looks. Buy it for life.®

Illustrated Parts

■ Order by Part Number

- 1st generation valve manufactured prior to September 3rd, 2009. Can be identified by the check stop nut.
- 130156 Thermostatic cartridge will not work in 2nd generation valves.

**ExactTemp®
3/4" Thermostatic Valve**

**MODEL
S3371**

