

# QUICK START GUIDE

## MOWRO™

By  redback

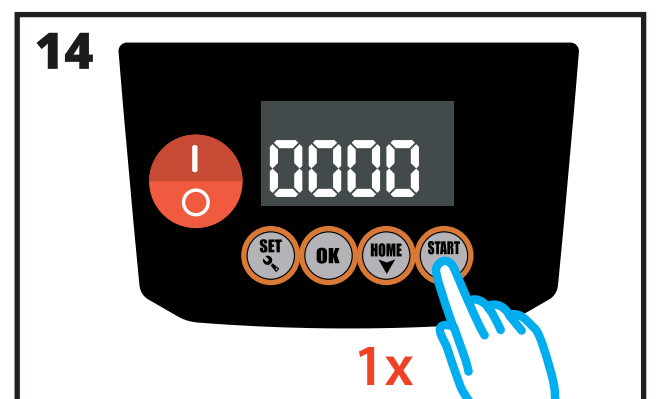
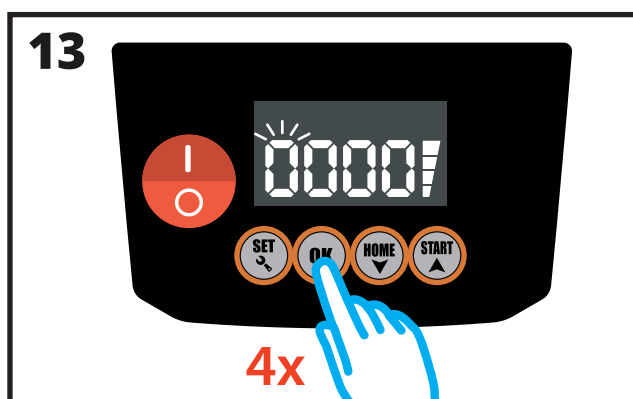
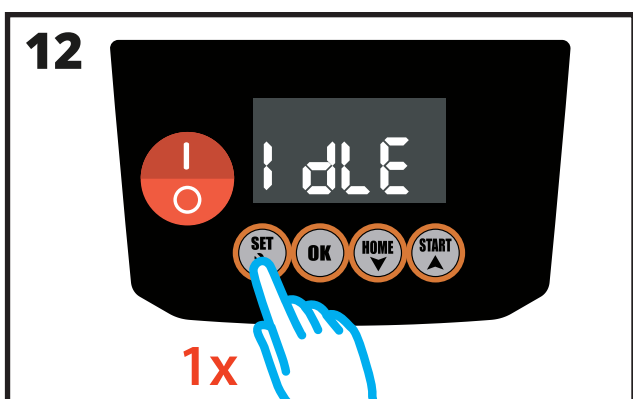
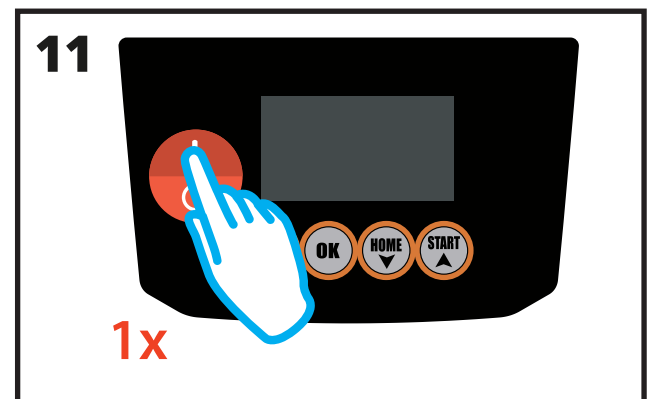
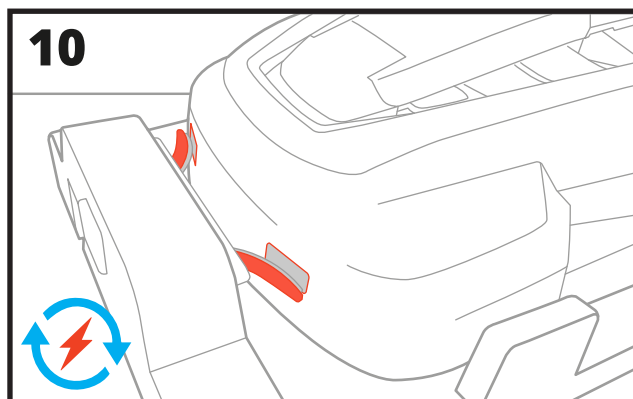
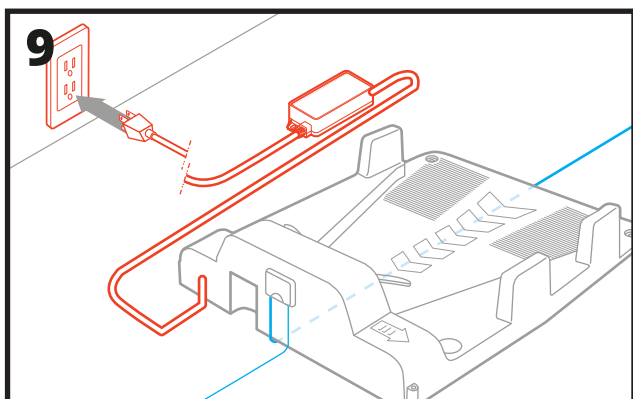
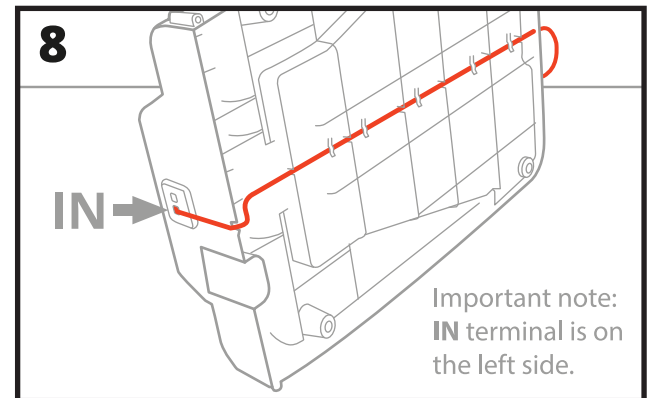
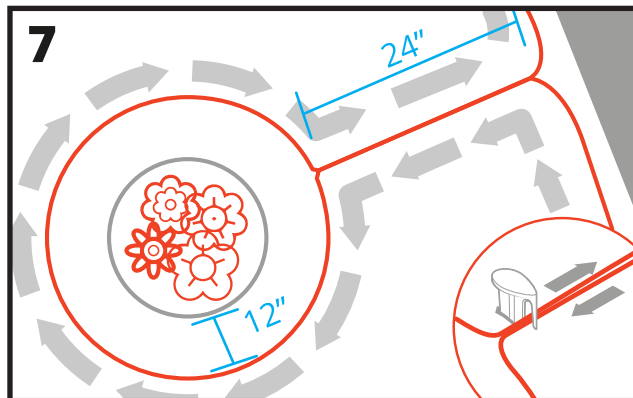
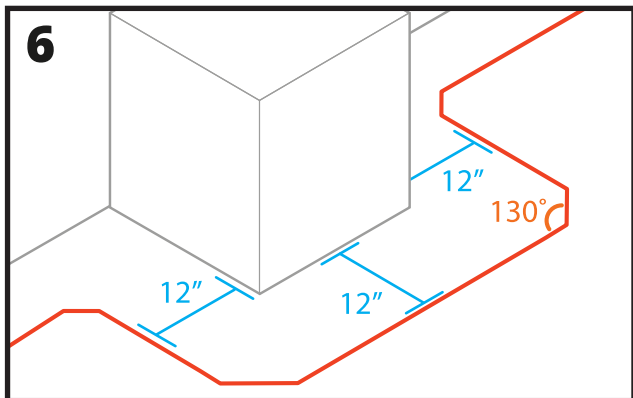
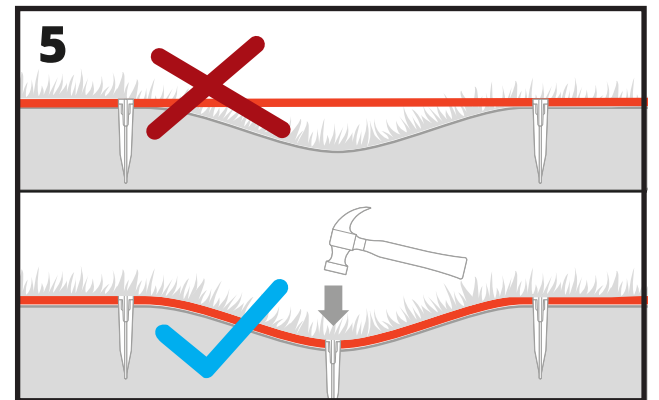
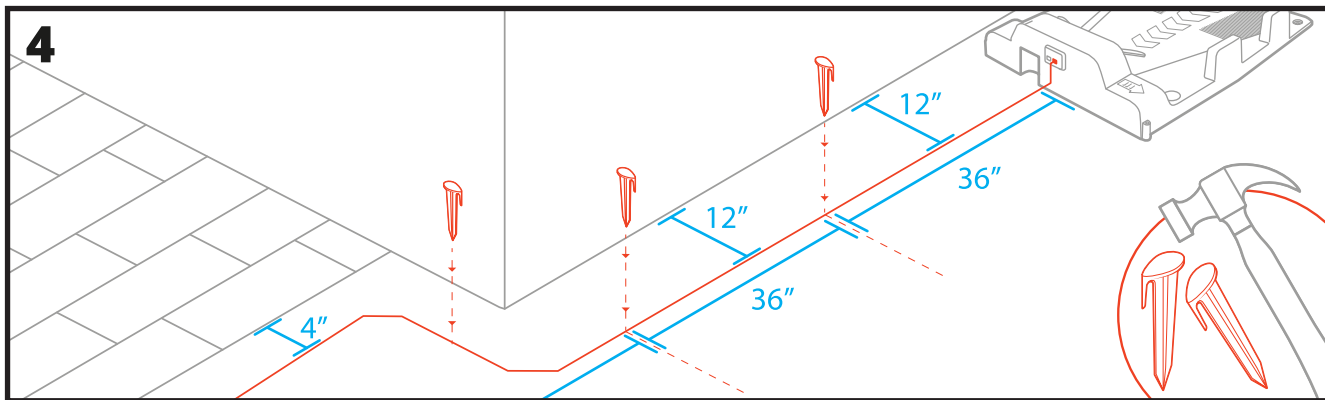
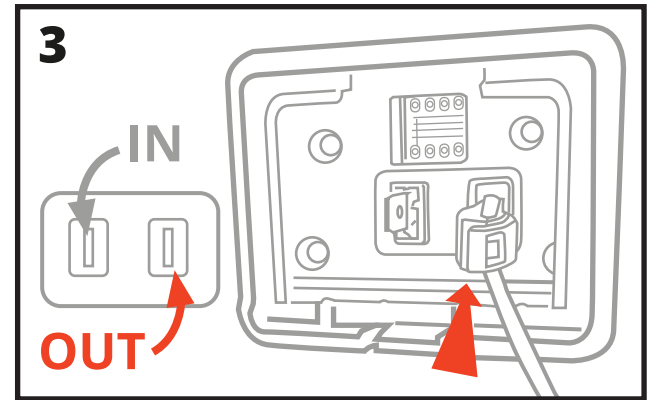
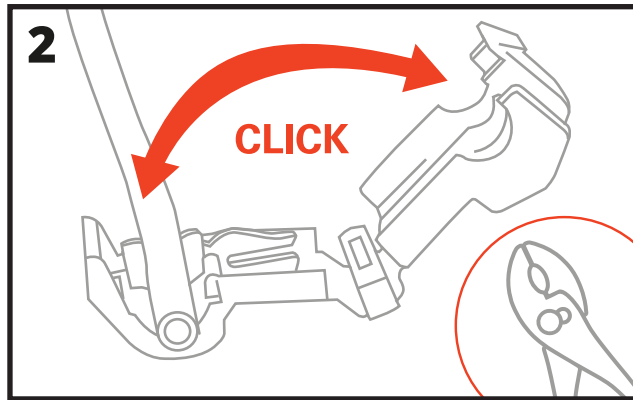
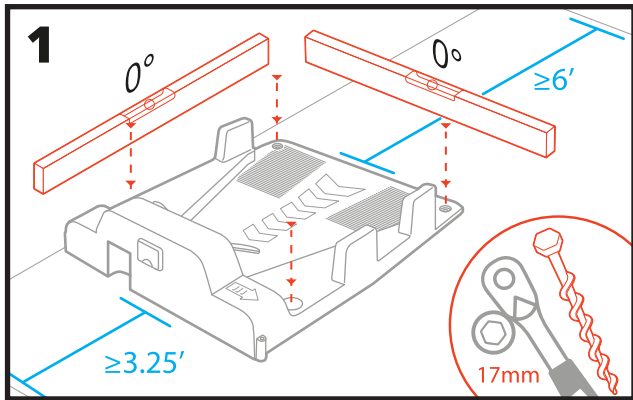
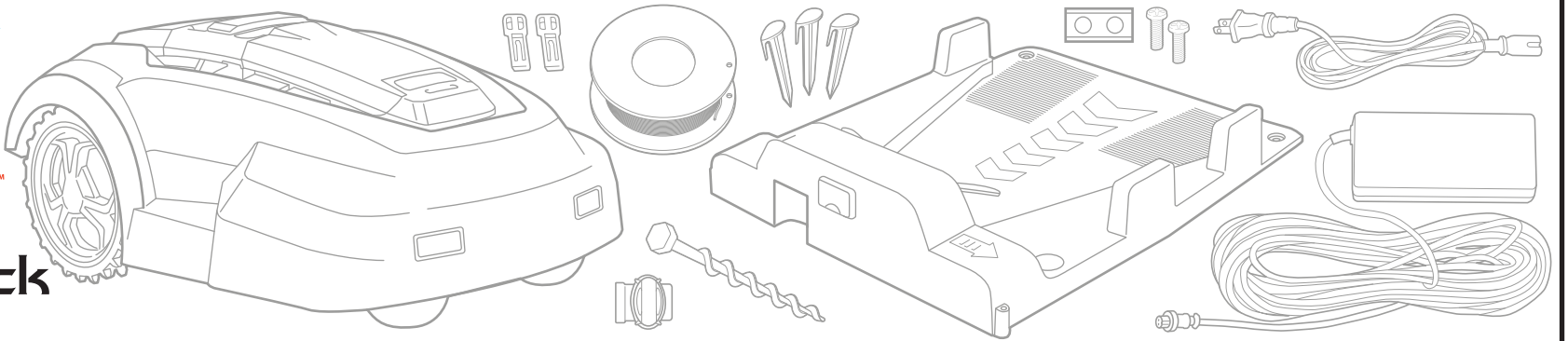

To customize program see operators manual

# Information Codes

**Information Codes:** Displayed on LCD Screen NOTE: How to Manually Restart - Place the machine within 1m near the boundary line, enter correct PIN code, then press "start".

Status Code	Cause	Solution
E1	STOP Button has been engaged.	Manually restart the mower.
E2	Lift sensor has been triggered.	Robot mower lifted? Wheel blocked? Remove foreign objects then manually restart the mower.
E3	Robot mower is out of the boundary line perimeter.	Relocate the robot mower in the boundary line perimeter then manually restart.
E4	No boundary line signal.	Check the status of the LED on the charging station. If it is blinking red, the boundary line is cut or the boundary wire is not properly connected to the docking station. Check boundary wire connection.
E5	A collision sensor is triggered.	Remove any obstacles or relocate the robot mower. Then manually restart the mower.
E6	Overcurrent on left propulsion motor.	Grass too tall and thick? Wheel blocked? If grass is > 2.6" tall cut with traditional mower. If grass is < 2.6" adjust height on mower to make sure the cutting can move without restriction.
E7	Overcurrent on right propulsion motor.	Grass too tall and thick? Wheel blocked? If grass is > 2.6" tall cut with traditional mower. If grass is < 2.6" adjust height on mower to make sure the cutting can move without restriction.
E8	Overcurrent on cutting motor.	Grass too tall and thick? Wheel blocked? If grass is > 2.6" tall cut with traditional mower. If grass is < 2.6" adjust height on mower to make sure the cutting can move without restriction.
E9	Faulty battery.	Battery malfunction, contact customer service.
E10	Under voltage of battery detected.	Place the robot mower back to the charging station and manually restart the mower. If the issue persists, please contact customer service.
E11	Tilt sensor triggered.	Tilting angle > 30°? Robot mower is overturned? Place the robot mower on flat ground and manually restart mower. All wheels must be on the ground to return to operation.
E12	Wheel spinning without grip.	Robot mower stuck in sand or holes? Check the surrounding lawn, place the robot mower on flat ground and manually restart the mower.
E13	Battery overheat.	If this issue persists, please contact customer service.
F1	Robot is out of boundary line perimeter.	Robot mower is outside boundary wire? Boundary line is connected reversely? Robot mower is too far from the boundary line? Check boundary line connections, place mower inside wire perimeter, manually restart mower.
F2	Won't start after pressing "start" button, boundary line signal not available.	Check the status of the LED on the charging station. If it is blinking red, boundary line is cut or the boundary wire is not properly connected to docking station. Check boundary wire connection.
F3	Won't start after pressing "start" button, bad charging contact.	Clean the charging contacts and remove any foreign objects. Place mower back in docking station and allow it to charge fully. Manually start mower while in the docking station.
F4	Won't start after pressing "start" button, battery voltage is too low.	Return the robot mower to the charging dock and let it fully recharge.