

ELECTRIC POWER TOOLS

Template Guides

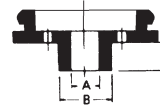

A	B	C	Model	Part#
19/64	3/8	29/64		164379-4
23/64	7/16	33/64		164775-6
7/16	1/2	33/64		164776-4
9/16	5/8	33/64	3612 3612BRA 3612C 3620	164835-4
45/64	25/32	33/64		164393-0
15/16	1-1/16	33/64		164470-8
63/64	1-9/64	19/32		163080-8
1-1/16	1-3/16	33/64		164471-6
1-29/64	1-37/64	29/64		164472-4
5/16	3/8	5/16		323448-2
7/16	1/2	5/16		323449-0
9/16	5/8	5/16	3601B	323018-7
9/16	5/8	9/16		321308-2
11/32	7/16	3/16		323023-4
57/64"	1"	7/16"		193235-1
21/32"	3/4"	9/16"		193261-0
11/32"	7/16"	5/32"		193262-8
13/32"	1/2"	5/16"		193263-6
9/32"	3/8"	5/16"	RP1101	193264-4
5/8"	51/64"	9/16"	RF1101 Kit	193265-2
17/32"	5/8"	9/16"	RF1100	193266-0
1/4"	5/16"	5/32"	RF1101	193267-8
17/32"	5/8"	7/32"	RD1100	193366-6
3/4"	59/64"	9/16"	RD1101	193367-4
1-1/32"	1-3/16"	25/64"		193368-2
1-1/32"	1-1/4"	7/16"		193369-0
1-3/8"	1-35/64"	17/32"		193372-1
Locknut:				252627-4

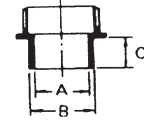

A	B	C	Model	Part#
57/64	1	7/16	3601B 3606 3612 3612BRA 3612C 3620	321812-1
Must be used with template guide lock nut (252627-4) and template guide adapter (321492-3) or (321493-1) for 3601B.				
Nut M30				252627-4
Template guide adapter 30 (321492-3) or (321493-1)				
Template guide 25 (321812-1)				

ROUTER & CUTOUT TOOL

Accessories

Straight - Single Flute

For rough routing, grooving and general stock removal. Single flute gives more efficient chip clearance for improved feed rates. 1/2" shank bits are for maximum strength production use.

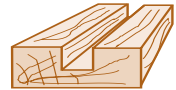
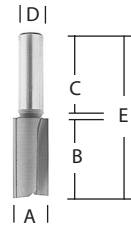

Type	A	B	C	D	E	Part#
Carbide Tipped	1/4	1	1-3/16	1/4	2	733001-0A
Carbide Tipped	1/2	2	2-1/16	1/2	4-1/4	733002-6A

Straight - 2 Flute, 1/4" Shank

For general purpose routing and grooving where smoothness of cut and minimal vibration are desired

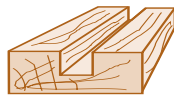
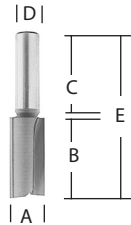

Type	A	B	C	D	E	Part#
Solid Carbide*	1/8	7/16	1-3/8	1/4	2	733003-1A
Carbide Tipped	1/16	1/4	1-1/8	1/4	1-5/8	733250-A
Carbide Tipped	3/16	7/16	1-3/8	1/4	2	733003-2A
Carbide Tipped	1/4	3/4	1-3/16	1/4	2	733003-4A
Carbide Tipped	1/4	1	1-3/16	1/4	2	733003-6A
Carbide Tipped	5/16	1	1-1/8	1/4	2	733003-8A
Carbide Tipped	3/8	1	1-1/8	1/4	2-1/4	733004-0A
Carbide Tipped	7/16	1	1	1/4	2-1/8	733004-1A
Carbide Tipped	1/2	1	1-1/8	1/4	2-1/8	733004-2A
Carbide Tipped	5/8	3/4	1-1/8	1/4	2	733004-4A
Carbide Tipped	3/4	3/4	1-1/8	1/4	2	733004-6A

2 Flute Flush Trimmer

For fast, smooth and accurate 90° flush trimming applications. Non marring ball bearing pilot. 1/4" REPLACEMENT BEARING NO. 733132-1A 3/8" REPLACEMENT BEARING NO. 733132-2B 1/2" REPLACEMENT BEARING NO. 733132-4A

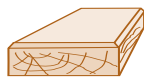
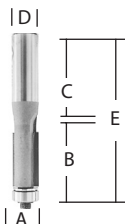

Type	A	B	C	D	E	Part#
Carbide Tipped	1/4	1/2	1	1/4	2-1/2	733128-1A
Carbide Tipped	3/8	1/2	1	1/4	2	733128-7A
Carbide Tipped	3/8	1	1-1/4	1/4	2-1/2	733128-8A
Carbide Tipped	1/2	1/2	1-1/4	1/4	2	733128-9A
Carbide Tipped	1/2	1	1-1/4	1/4	2-1/2	733129-0A
Carbide Tipped	1/2	1	1-1/4	1/2	3	733129-1A
Carbide Tipped	1/2	2	1-1/4	1/2	4	733274-A

Straight - 2 Flute, 1/2" Shank

Larger 1/2" shank is stronger for production use situations

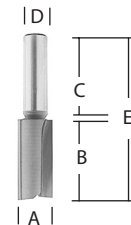

Type	A	B	C	D	E	Part#
Carbide Tipped	3/8	1	1-1/4	1/2	2-3/4	733005-4A
Carbide Tipped	1/2	1	1-5/16	1/2	2-5/8	733252-A
Carbide Tipped	1/2	1-1/4	1-7/16	1/2	2-7/8	733005-6A
Carbide Tipped	1/2	1-1/2	1-1/4	1/2	3-1/8	733005-8A
Carbide Tipped	1/2	2	2	1/2	4-1/4	733005-9A
Carbide Tipped	1/2	2-1/2	1-1/16	1/2	4-1/2	733254-A
Carbide Tipped	3/4	1-1/4	1-1/4	1/2	2-7/8	733006-4A
Carbide Tipped	7/8	1-1/4	1-3/16	1/2	2-7/8	733006-6A
Carbide Tipped	1	1-1/4	1-3/16	1/2	2-7/8	733006-8A

Core Box

For high quality radius cuts, rounded grooves, letter cutting, reeding, fluting and general ornamentation.

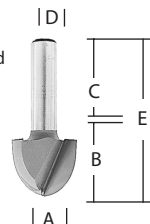

Type	A	B	C	D	E	Part#	
Carbide Tipped	Radius	1/4	15/32	1-1/4	1/4	1-1/2	733008-2A
Carbide Tipped	1/8	3/8	9/16	1-1/4	1/4	1-1/2	733008-4A
Carbide Tipped	3/16	1/2	11/16	1-1/4	1/4	1-1/2	733008-6A
Carbide Tipped	1/4	5/8	11/16	1-1/4	1/4	1-1/2	733008-8A
Carbide Tipped	5/16	3/4	13/16	1-1/4	1/4	1-1/2	733009-0A
Carbide Tipped	3/8	1	5/8	15/16	1/4	1-3/4	733270-A
	1/2"						