

# 18V X2 LXT® LITHIUM-ION (36V) BRUSHLESS CORDLESS 4 GALLON HEPA FILTER DRY DUST EXTRACTOR, TOOL ONLY



## NEW TOOL OVERVIEW XCV15ZX



Uses **2**  
18V LXT®  
Batteries

Batteries  
not included



## LXT® X2 18V + 18V 36V BRUSHLESS

### FEATURES

- Powerful Makita-built BL™ Brushless motor delivers 74 CFM and 39" water lift of suction using two 18V LXT® Lithium-Ion batteries (batteries not included)
- Efficient three stage HEPA filtration system captures 99.97% of particulates .3 microns and larger
- Filter cleaning system is designed to maintain optimal suction efficiency and longer filter life
- Up to 75 minutes of continuous run time on low setting and 40 minutes on high setting using two 18V LXT® Lithium-Ion 5.0Ah batteries BL1850B (batteries not included)
- Efficient BL™ Brushless motor is electronically controlled to optimize battery energy use for up to 50% longer run time per charge
- The BL™ Brushless Motor eliminates carbon brushes, enabling the BL™ Motor to run cooler and more efficiently for longer life
- Oversized on-off switch for operator convenience
- Motor chamber constructed of quality sound-absorbing materials for quiet operating sound levels of 66 dB(A)

### SPECIFICATIONS

|   |                         |
|---|-------------------------|
| <b>Gross Container Size</b> .....             | 4 gal.                  |
| <b>Air Flow Rate</b> .....                    | 74 CFM                  |
| <b>Static Water Lift</b> .....                | 39"                     |
| <b>Continuous Use (max, in minutes)</b> ..... | 75 min.                 |
| <b>Battery</b> .....                          | 2X 18V LXT® Lithium-Ion |
| <b>Filter Cleaning</b> .....                  | Yes                     |
| <b>HEPA filter</b> .....                      | Yes                     |
| <b>Equipped Filter Efficiency</b> .....       | 99.97% of .3 microns    |
| <b>Working Sound Level</b> .....              | 66 dB(A)                |
| <b>Net Weight (with battery)</b> .....        | 19 lbs.                 |
| <b>UPC Code</b> .....                         | 088381-883399           |
| <b>Power Type</b> .....                       | Cordless                |

### STANDARD EQUIPMENT

- Anti-Static Hose, 1" x 11' (195433-3)
- Tool Cuff Adapter, 22mm for 1" hose (417765-1)
- Tool Cuff Adapter, 24mm for 1" hose (424379-9)
- Tool Cuff Adapter, 38mm for 1" hose (417766-9)
- Plastic Disposal Bag, 10/pk (195432-5)
- HEPA Filter (197166-6)
- Damper Filter (423398-2)
- Pre-Filter (195553-3)

### PRODUCT HIGHLIGHTS



#### POWER

Makita BL™ Brushless motor delivers 74 CFM using two 18V LXT® batteries (batteries not included)



#### RUN TIME

Up to 75 minutes of continuous run time on low setting and 40 minutes on high setting



#### EFFICIENCY

Efficient three stage HEPA filtration system captures 99.97% of particulates .3 microns and larger

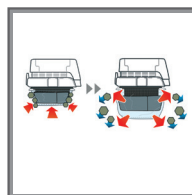

#### DURABILITY

Filter cleaning system is designed to maintain optimal suction efficiency and longer filter life

### RELATED PRODUCTS

1. Filter Dust Bag, 5/pk (195557-5)
2. Anti-Static Hose, 1-1/2" x 8' (195434-1)
3. Curved Pipe (192562-3)
4. Straight Pipe (192563-1)
5. 12" Universal Floor Nozzle (122512-4)

