



4-1/2" & 5" SJS™ II High-Power Angle Grinders

Modelos GA4542C & GA5042C

ELECTRONIC CONTROLLER FOR OPERATOR CONVENIENCE

- Powerful 12.0 AMP motor delivers more output and variable (2,800 - 11,000) RPM
- SJS™ II provides a mechanical gear drive system to help prevent motor and gear damage by dampening the force on the gear when the wheel is forced to stop
- SJS™ II provides a leaf spring and cam gear drive mechanism that is engineered to reduce vibration for increased operator comfort during extended use
- Vibration absorbing side handle provides increased comfort on the job

POWER

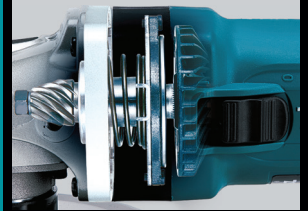

Powerful 12.0 AMP motor delivers more output and 2,800 - 11,000 RPM

DURABILITY

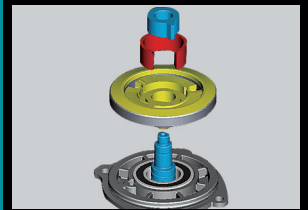

SJS™ II technology is a mechanical gear drive system that helps prevent motor and gear damage

COMFORT

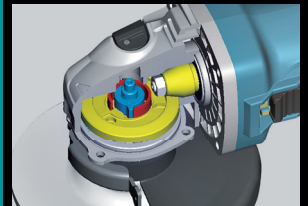

SJS™ II technology is a leaf spring and cam gear drive mechanism engineered to reduce vibration

VERSATILITY



Variable speed control dial enables user to match the speed to the application



SJS II

LESS VIBRATION

4-1/2" & 5" SJS™ II High-Power Angle Grinders

Models GA4542C & GA5042C

FEATURES & BENEFITS

- Electronic controller provides constant speed control which automatically applies additional power to the motor to maintain speed under load
- Electronic controller provides soft start which suppresses start-up reaction for smooth start-ups and longer gear life
- Labyrinth construction seals and protects the motor and bearings from dust and debris for longer tool life
- Variable speed control dial enables user to match the speed to the application
- Labyrinth construction seals and protects the motor and bearings from dust and debris for longer tool life
- Zig-zag varnish protects the armature coil from dust and debris for longer tool life
- Spiral bevel gears for smoother rotations and a more efficient transfer of energy
- "Tool-less" wheel guard for easy adjustment
- Slide switch with lock-on for continuous use

STANDARD EQUIPMENT

- Inner Flange (224399-1)
- "Tool-less" Wheel Guard (123145-8)
- Lock Nut (224568-4)
- Lock Nut Wrench (782412-6)
- Side handle (162258-0)
- 4-1/2" x 1/4" x 7/8" INOX grinding wheel (A-95956)
GA4542C Only
- 5" x 1/4" x 7/8" INOX grinding wheel (A-95962)
GA5042C Only

SPECIFICATIONS

	GA4542C	GA5042C
Grinding Wheel or Sanding Disc	4-1/2"	5"
Wire Cup Brush	3-1/2"	3-1/2"
No Load Speed (Variable Speed)	2,800 - 11,000 RPM	
Spindle Thread	5/8"-11 UNC	5/8"-11 UNC
AMPS	12	12
Lock-On	Yes	Yes
Lock-Off	No	No
Overall Length	11-7/8"	11-7/8"
Net Weight	5.4 lbs.	5.4 lbs.
UPC Code	088381-699761	088381-697996



Model GA4542C



Model GA5042C



OPTIONAL ACCESSORIES

- 4-1/2" x 1/4" x 7/8" INOX grinding wheel
(1 pk. A-95956), (5 pk. A-95956-5), (25 pk. A-95956-25)
- 5" x 1/4" x 7/8" INOX grinding wheel
(1 pk. A-95962), (5 pk. A-95962-5), (25 pk. A-95962-25)
- 4-1/2" x 1/4" x 5/8"-11 INOX grinding wheel
(1 pk. A-95984), (5 pk. A-95984-5), (25 pk. A-95984-25)
- 5" x 1/4" x 5/8"-11 INOX grinding wheel
(1 pk. A-95990), (5 pk. A-95990-5), (25 pk. A-95990-25)



Makita offers a wide variety of accessories. For a complete listing, please refer to the Makita General Catalog or visit our website at makitatools.com, or call 1-800-4MAKITA.

All specifications subject to change without prior notice. All models and accessories subject to stock on hand.
The Makita Teal Color is the trade dress of Makita Corporation and is protected under common law and registered with the U.S. Patent and Trademark Office.
NTF-0315-MA-5039-15