

Setting the Control Panel. (Recirculation system)

To set the recirculation type (External or Internal mode)

1. Turn off the power to the control panel. Press and hold the 'Function Button' for approximately 5 seconds to get into the 'Installer mode'.

2. Turn the dial button in 'Installer mode' to '[1:RC]'.
3. 'oFF' character is flashed when the dial button is pressed.
(Default setting is 'oFF' and recirculation function is turned off.)
4. Turn the dial button clockwise to select 'on' in order to activate the recirculation function.
5. Press the dial button to store the current setting and return back to 'Installer mode'.

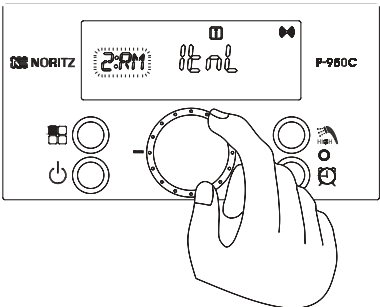
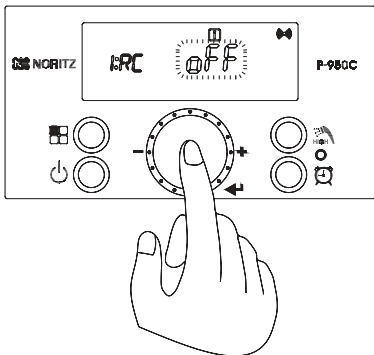
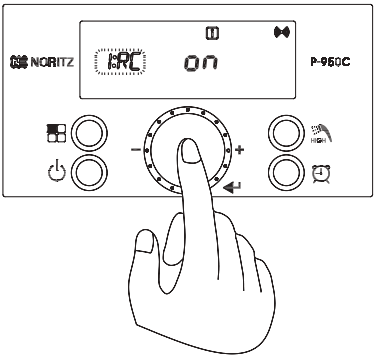
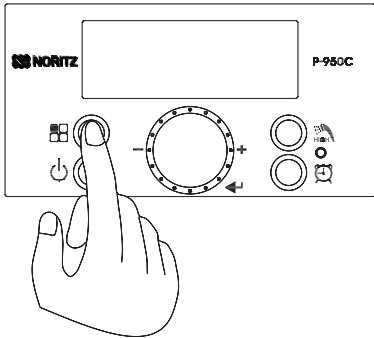

6. Locate '[2:RM]' by turning the dial button clockwise by one click.
7. Press the dial button when the flashing [2:RM].
8. Turn the dial button to select [Etnl] 'External Recirculation Mode' or [ltnl] 'Internal Recirculation Mode'.

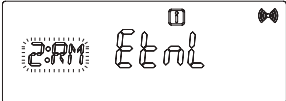
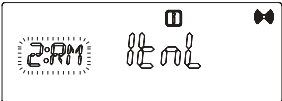
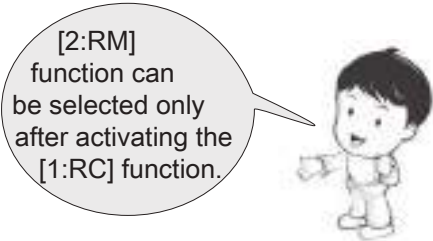

Screen Display	Operation	Description
ltnl	Internal Recirculation Mode	Internal recirculation system is operated during [1:RC] mode turned on.
Etnl	External Recirculation Mode	External recirculation system is operated during [1:RC] mode turned on.

Setting the Control Panel. (High Elevation)**To set the High Elevation**

1. Turn off the power to the control panel. Press and hold the 'Function Button' for approximately 5 seconds to get into the 'Installer mode'.
4. Turn the dial button clockwise to select the value that corresponds to the installation elevation.

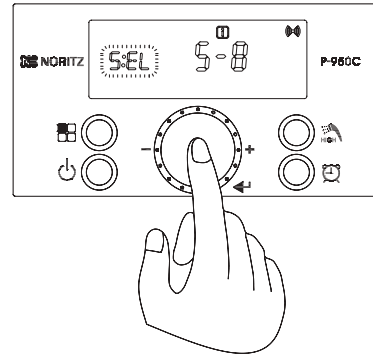
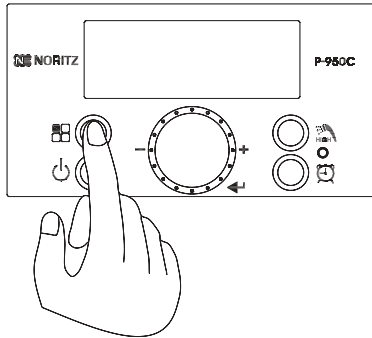

2. In 'Installer Mode,' turn the dial button clockwise until the display reads '[5:EL]'.
3. '0-2' will flash when the dial button is pressed. (The default setting is '0-2' for installations at 0-2,000 ft elevation)
5. Press the dial button to store the current setting and return back to 'Installer mode'.

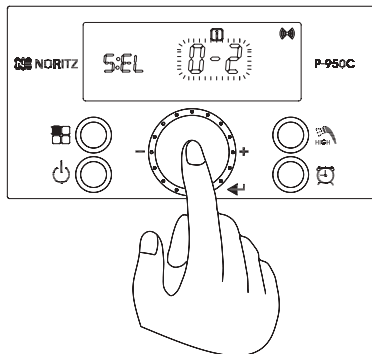

4-9. Quick Connect Multi System Installation

The Quick Connect Multi System allows the installation of two units together utilizing only the Quick Connect Cord.

- Quick Connect Multi System cannot allow more than 2 units.
- All units within Quick Connect Multi System must be of the same model.
- Different models cannot work as Quick Connect Multi System.

The Quick Connect Cord is 6 ft. (1.8m) long. Install the units 2-18" (50 - 457mm) apart from each other to ensure the cable will be able to reach between the units. (See Typical Plumbing diagram). (If the distance between the two units is too great, not only the cable won't be able to reach, but the water temperature may also become unstable because of the difference in pipe length between the two units).

■ System Diagram

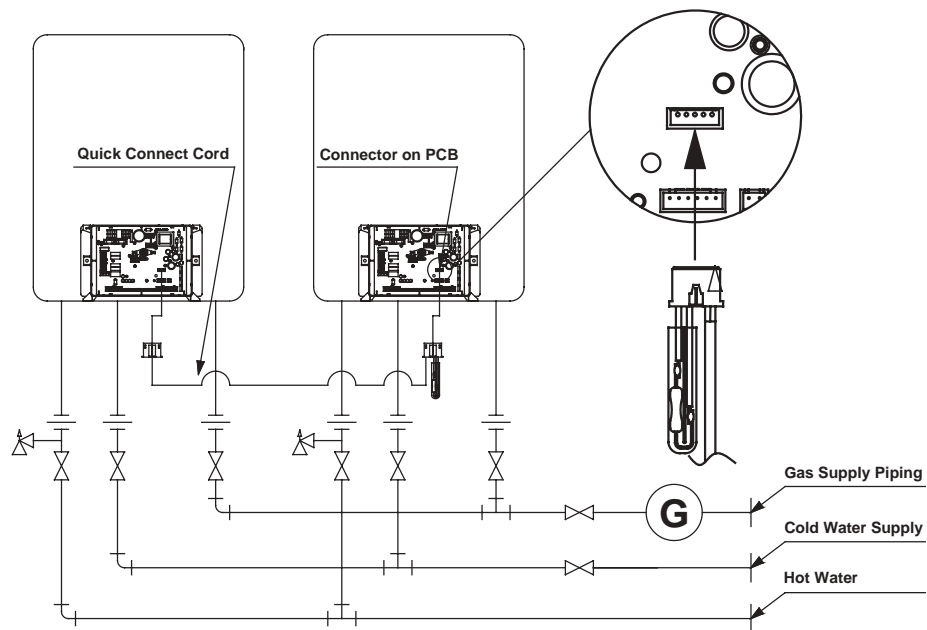

■ Typical Plumbing

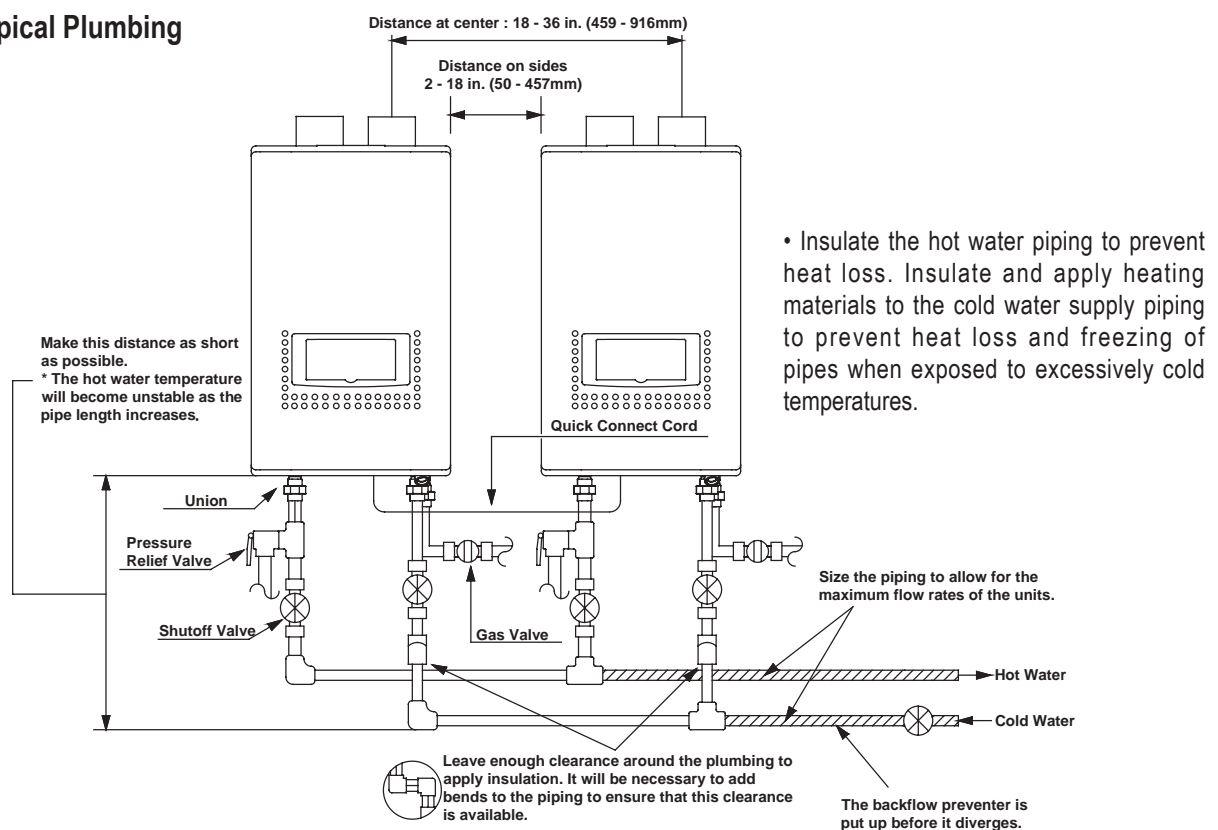

※ All units must be set to the same settings listed below before using in the Quick Connect Multi System.

1. Set "on" at [6:QC] in installer mode (Refer to below)
2. Current Clock Setting. (Refer to page 31 in the Installation Manual)
3. Recirculation Timer Setting, if recirculation is used. (Please refer to pages 22-27 in the Owner's Guide)

<Note>

Auto (Self Learning Mode) Recirculation function is not available with the Quick Connect Systems.

■ Connecting the Quick Connect Cable to the two units.

1. Turn off the power.
2. Remove the front covers for both of the heaters (4 screws each)
3. Pass the Quick Connect Cord through the wiring throughway at the bottom of the units.
4. Plug the wire connector into the 'Main PCB' connector inside both units.
5. Replace the front covers.
6. Turn on the power.

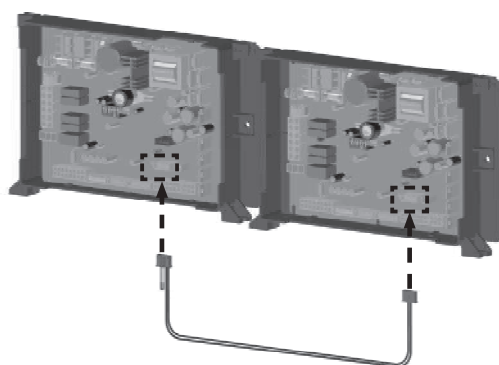

1. Turn off the power to the control panel. Press and hold the 'Function Button' for approximately 5 seconds to get into the 'Installer mode'.

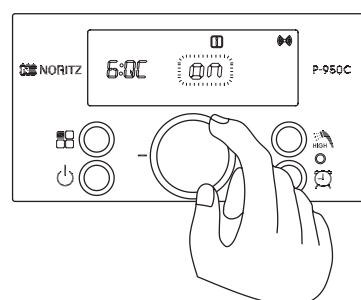
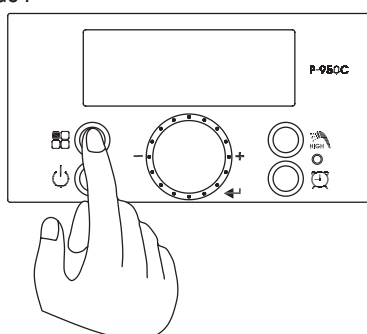

2. Turn the dial button to '[6:QC]'
3. Press the dial button, the "oFF" character will now be flashing.
4. Turn the dial button clockwise to select 'on' in order to activate Quick Connect Multi System function.
5. Press the dial button to store the current setting and return back to 'Installer mode'.
6. Repeat this procedure for the second unit.

Index	Parameter	Description
CA01	Quick connect mode : Master water heater	If 'Quick connect mode' is activated, [CA01]/[CA02] character appears on the display screen..
CA02	Quick connect mode : Slave water heater	

<Note>

CA:01(Master) unit will be able to set as first setting "on" at [6:QC] in installer mode.
Other unit will be automatically set CA:02(Slave) as second setting "on" at [6:QC] in installer mode.

4-10. Common Vent

When Noritz water heaters are installed in a Noritz Quick Connect Multi System, you can install a common venting system. Do not use common venting if the water heater is used within a Noritz Quick Connect Multi System with other manufacturer's water heaters or other models. Include a condensate drain in the main trunk as illustrated in the following examples.

1. Turn off the power to the control panel. Press and hold the 'Function Button' for approximately 5 seconds to get into the 'Installer mode'.

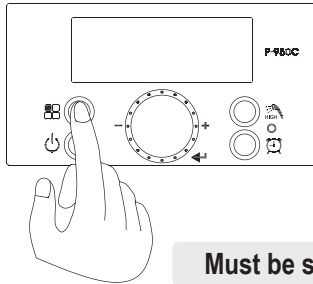

3. Press the dial button, the "on" or "oFF" character will be flashing.

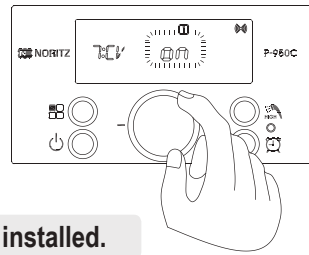

Must be set up each product installed.

2. Turn the dial button to '[7:CV]'.

<Note>

If [6:QC] is turned on, then [7:CV] will automatically be on when first set.

4. Turn the dial button counter-clockwise to select "oFF" if you want to install with a individual venting system for each unit, or turn the dial button clockwise to select "on" if you want to use the common venting feature.
5. Press the dial button to store the current setting and return back to 'Installer mode'.

The following are examples of common venting options:

<Warning>

This Common Vent System must be installed by a licensed technician, failure to properly install this system may result in property damage, serious injury to occupants, or possibly death.

Venting Intake and Exhaust (Direct Vent)

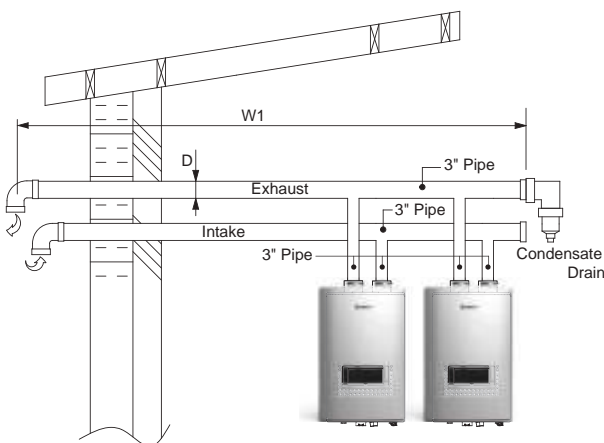

Venting Intake and Exhaust to the sidewall

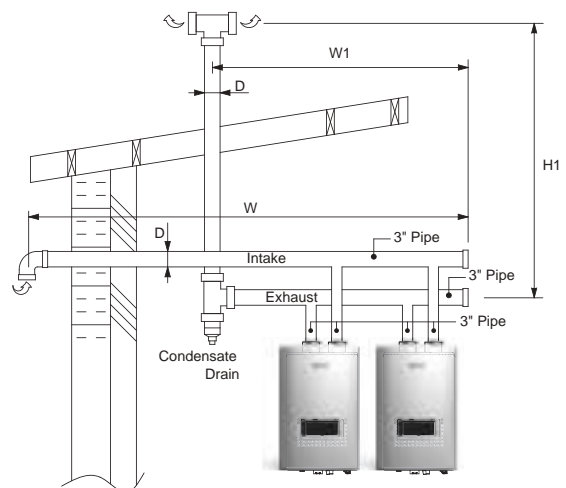

Venting Intake and Exhaust to the different location

<Note>

1. For clearance requirements between the exhaust and intake determinations refer to pg. 16-18 of the Installation Manual.
2. Insert bird screen on elbow terminals.
3. Make sure condensate drain hole size should be more than 1/2".

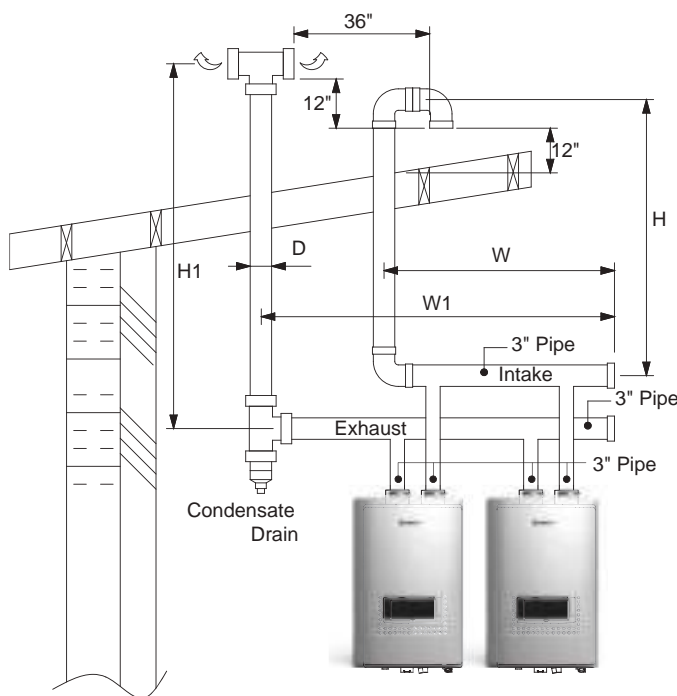

Venting Intake and Exhaust to the roof

● To determine the size of a common vent:

Determine the total length (L) of the common vent, which consist of the horizontal width (W/W1) and vertical height (H/H1)

$$\text{Total Length (L)} = W + H + W1 + H1$$

Require Load Total BTU/H	Total Length (ft)
398,000	100 (30m)

● Maximum Vent Length

No. of Elbows	Max. straight vent length
4	68'
3	76'
2	84'
1	92'
0	100'

<Note>

For each short radius elbow that will be used in the vent, add 8 feet (2.4 m) to the total length. For each long radius elbow that will be used in the vent, add 5 feet (1.5m) to the total length.

Venting the Exhaust only (Non-Direct)

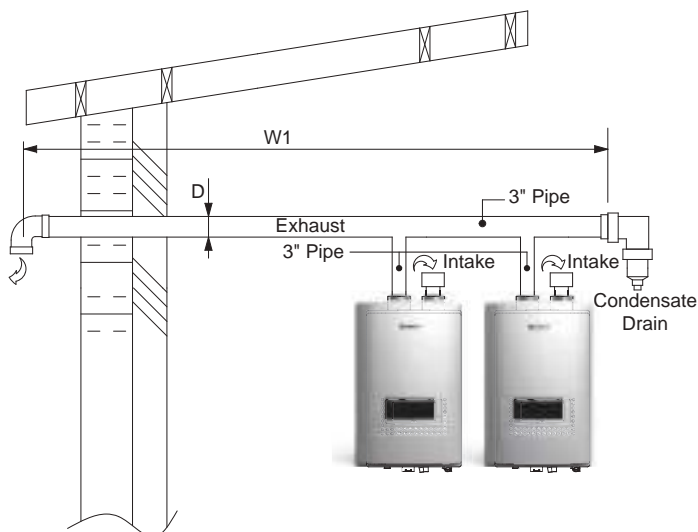

Venting the Exhaust only to the side wall

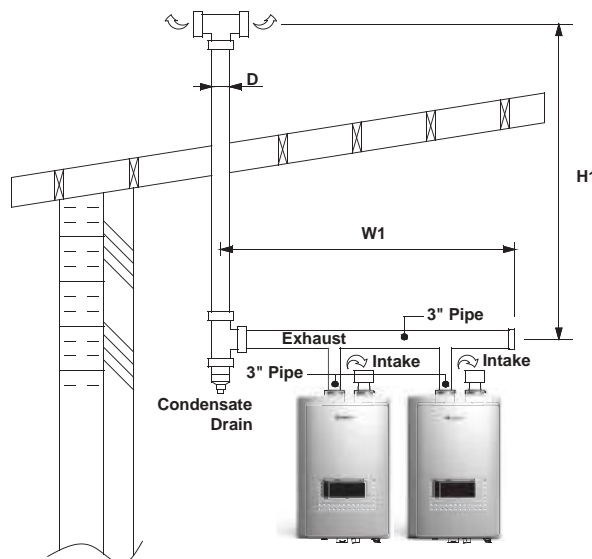

Venting the Exhaust only to the roof

5-1. Maintenance Periodically check the following to ensure proper operation of the water heater..

- The venting system must be examined periodically by a qualified service technician to check for any leaks or corrosion.
- The burner flame must be checked periodically for a proper blue color and consistency.
- If the flame does not appear normal, the burner may need to be cleaned.
- If the burner needs to be cleaned, it must be performed by a qualified service technician.
- Do not obstruct the flow of combustion and ventilation air.
- The pressure relief valve must be operated once a year to ensure that it is functioning properly and there is no obstruction. Turn the power off to the unit before opening the relief valve, and make sure that water draining out of the valve will not cause any damage.
- If the relief valve discharges periodically, it may be due to thermal expansion in a closed water system. Contact the water supplier or a local plumbing inspector on how to correct this situation. Do not plug the relief valve.
- See Operation Manual for further maintenance.

⚠ WARNING

There is a scald potential if the output temperature is set too high.

Should overheating occur, or the gas supply fail to shut off, turn off the manual gas control valve to the appliance.

Do not use this appliance if any part has been under water. Immediately call a qualified service technician to inspect the appliance and to replace any part of the control system and any gas control which has been under water.

Periodically check and clean the filter inside the cold water inlet of the unit.

MAINTENANCE REPORT**⚠ CAUTION**

In unusually dirty or dusty conditions, care must be taken to keep water heater cabinet door in place at all times. Failure to do so VOIDS WARRANTY!

⚠ WARNING

Allowing the water heater to operate with a dirty combustion chamber will hurt operation. Failure to clean the heat exchanger as needed by the installation location could result in water heater failure, property damage, personal injury, or death. Such product failures ARE NOT covered under warranty.

The water heater requires minimal periodic maintenance under normal conditions. However, in unusually dirty or dusty conditions, periodic vacuuming of the cover to maintain visibility of the display and indicators is recommended.

Periodic maintenance should be performed once a year by a qualified service technician to assure that all the equipment is operating safely and efficiently. The owner should make necessary arrangements with a qualified heating contractor for periodic maintenance of the water heater. Installer must also inform the owner that the lack of proper care and maintenance of the water heater may result in a hazardous condition.

INSPECTION ACTIVITIES		DATE LAST COMPLETED			
Piping		1st YEAR	2nd YEAR	3rd YEAR	4th YEAR
Near water heater piping	Check water heater and system piping for any sign of leakage. Leaking pipes could cause property damage. Make sure all piping is properly supported. Flush tankless heat exchanger annually (more in hard water conditions). See User's Information manual for instructions.				
Vent	Check condition of all vent pipes and joints. Ensure all vent piping is properly supported. Check for obstructions exhaust and intake termination points.				
Gas	Check Gas piping, test for leaks and signs of aging. Make sure all pipes are properly supported.				
SYSTEM					
Visual	Do a full visual inspection of all system components.				
Functional	Test all functions of the system (Heat, Safeties)				
ELECTRICAL					
Connections	Check wire connections. Make sure they are tight.				
Switch and Plug	Verify ON/OFF switch and convenience plug are both functional				
CONDENSATE					
Condensate Trap	Clean debris from the condensate trap. Fill with clean water.				
Neutralizer	Check condensate neutralizer. Replace if necessary.				
Condensate hose	Disconnect condensate hose. Clean out dirt and re-install. (NOTE: Verify the flow of condensate, making sure that the hose is properly connected during final inspection.)				
GAS					
Pressure	Measure incoming gas pressure (NG : 3.5" to 10.5" W.C.) (LP : 8.0" to 14" W.C.)				
Check gas pipe for leaks	Check piping for leaks. Verify that all are properly supported.				
COMBUSTION					
CO/CO2 Levels	Check CO and CO2 levels in Exhaust. Record at high and low fire.				

5-2. Final Check List

■ Final check : On the installation conditions.

- Is the Water Heater securely mounted on the wall?
- Is there space for a drain which is close to the Water Heater?
- Is there any combustible material near the Water Heater and vent pipe?
- Is the air supply sufficient for proper operation of the Water Heater?
- Are the proper service clearances maintained?
- Is the distance between the Water Heater and point of vent termination minimized?
- Are the proper space from windows, doors, and other intake vents maintained?

■ Final check : Gas pipe installation

- Is the gas supply line equipped with a manual shut off valve?
- Is the gas supply line a minimum of 3/4" inner diameter?
- Is the gas supply line length and diameter adequacy to deliver the required BTUs?
- Has the gas supply line pressure been measured?
- Does the gas type match with the type indicated on the rating plate?

■ Final check: Air / Vent pipe installation

- Has the Water Heater been vented with 2" or 3" PVC, CPVC, Polypropylene or BH Special Gas Vent (S636 PVC, CPVC) for Category IV appliances in accordance with this manual and/or your local code?
- Is the vent termination at least 12" above the exterior grade?
- Is the total vent length within the maximum vent length restriction?
- Have you checked the air/vent piping for leaks?
- Have you properly supported the vent termination?
- Are all vent runs properly supported?
- Is the vent sloped upward toward the vent termination at a rate of 1/4" per foot (2% grade)?

■ Final check : Condensate drain installation

- Have you installed a condensate drain line from the Water Heater to a drain or laundry tub?

■ Connecting the power supply

- Please check the power specifications. Is that AC 120V power?
- Have you checked the polarity of the electrical connection?

■ Final check : Pressure relief valve

- Have you installed an approved pressure relief valve on the water heater?
- Is the pressure relief valve of DHW Plumbing at least 3/4" in diameter?
- Have you installed the pressure relief valve on the hot water outlet pipe near the Water Heater?

■ Final check : Burner flames

- The burner flame must be checked periodically for a constant proper blue color.
- If the flame does not appear normal, the burner may need to be cleaned.
- If the burner needs to be cleaned, it must be performed by a qualified service technician.

Installation Manual

Register your Warranty online at www.noritz.com/warranty



NORITZ AMERICA CO. 11160 Grace Avenue Fountain Valley, CA 92708
Phone : 866 - 766 - 7489