

# Pre-Rinse Faucets

**TECK<sup>®</sup>**  
COMMERCIAL

**DELTA<sup>®</sup>**

## Specification: (example 55T15xx)

- **CAST BRASS Wallmount** pre-rinse faucet
- 203mm (8"), two handle, integral check stops
- **TUF-TECK<sup>®</sup>** compression structures
- Polished chrome plated finish trim
- ADA compliant, color indexed, vandal resistant, 76mm (3.0") metal lever blade handles
- 3/8" IPS rigid riser, wall bracket, spray head hook and ...
- with ... (add No. 5 product variation)
- with ... (add outlet required)
- with ... adjustable centers (add Suffix **AC** if required) (see Back Page)



**55T1513**

## Specification: (example 55T12xx & 55T13xx)

- **CAST BRASS Deckmount** pre-rinse faucet
- Two handle, inlet check tails
- Polished chrome plated finish
- **TUF-TECK<sup>®</sup>** compression structures
- ADA compliant, color indexed vandal resistant, 76mm (3.0") metal lever blade handles
- 3/8" IPS rigid riser, wall bracket, spray head hook and ... with ... (add product variation No. 2 or No. 3) with ... (add outlet required)

### Engineer/Architect Approval

Model Specified:

Approval:

Date:

DESCRIPTION	PRODUCT NO.		
Pre-Rinse Faucet	55T1		3

For 55T1090 Add-On Faucet, see back page



PRODUCT VARIATION	OUTLET	HANDLE
0 <input type="checkbox"/>	0 <input type="checkbox"/>	0 <input type="checkbox"/>
1 <input type="checkbox"/>	1 Spray with Spring Loaded S.S. Hose Auto Shut-off <input type="checkbox"/>	1 <input type="checkbox"/>
2 203mm (8") Deckmount Faucet <input type="checkbox"/>	2 <input type="checkbox"/>	2 <input type="checkbox"/>
3 102mm (4") Center Deckmount Faucet <input type="checkbox"/>	3 <input type="checkbox"/>	3 76mm (3") Lever Blade Handles <input checked="" type="checkbox"/>
4 <input type="checkbox"/>	4 <input type="checkbox"/>	4 <input type="checkbox"/>
5 203mm (8") Center Wallmount Faucet <input type="checkbox"/>	5 <input type="checkbox"/>	5 <input type="checkbox"/>
6 <input type="checkbox"/>	6 <input type="checkbox"/>	6 <input type="checkbox"/>
7 <input type="checkbox"/>	7 <input type="checkbox"/>	7 <input type="checkbox"/>
8 <input type="checkbox"/>	8 Same as No. 1 Above but with Add-On Faucet (S5), 1.5 USGPM (5.7 L/min.) Aerator (1) <input type="checkbox"/>	8 <input type="checkbox"/>
9 <input type="checkbox"/>	9 <input type="checkbox"/>	9 <input type="checkbox"/>

(1) Available **Optional Swing Spouts**. These spouts can ONLY be added to **Outlet Option No. 8** and **55T1090**. Refer to [www.specselect.com](http://www.specselect.com) for individual models.

Note: Use this page front and back as a product submittal sheet.

### Approvals:

- CSA certified
- Complies to ASME A112.18.1/CSA B125.1
- Lever Blade Handle  
ADA Compliant and meets Handicapped Accessibility Standard ICC/ANSI A117.1/ADA of less than 5 lbs. operating force.
- Verified compliant with 0.25% weighted average Pb content regulations.
- "For Commercial Use Only"  
(Contact Delta Representative for State and/or Local Approvals.)

### FLOW RATE vs PRESSURE

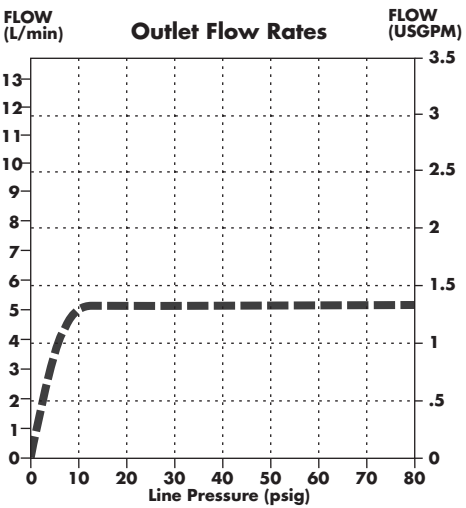

<b>Add-On Spout Outlet</b>
■ Aerator
<b>Flowrate w/ Standard Pre-Rinse Spray Outlet</b>
1.6 USGPM @ 60 PSI
<b>Flowrate w/ Energy Saver Pre-Rinse Spray Face</b>
(Also supplied with standard product)
1.2 USGPM @ 60 PSI

**PRODUCT VARIATION No. 5**  
**INLETS** - 1/2 - 14 NPT (Female) or 1/2 - 14 NPT (Male) with Supplied Nipple

**PRODUCT VARIATION No. 2 & 3**  
**INLETS** - 3/8 or 1/2" Flexible Riser or 1/2 - 14 NPSM Coupling Nut (Supplied)

Note: Measurements may vary ± 6mm (0.25")

### Wallmount Faucet ADJUSTABLE CENTERS

ADD Suffix "AC" to Product Number

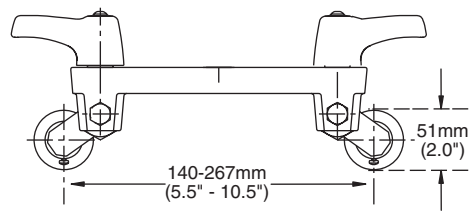

### WALL BRACKET

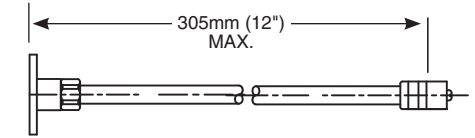

**MODEL No. 55T1090**  
 (Will add 152mm (6") to overall height if ordered and installed separately.)

**FOR OPTIONAL SWING SPOUTS**  
 See DSP-S/S for detailed specification  
 (Found in the "Add-On Option" section when using the printed spec binder)

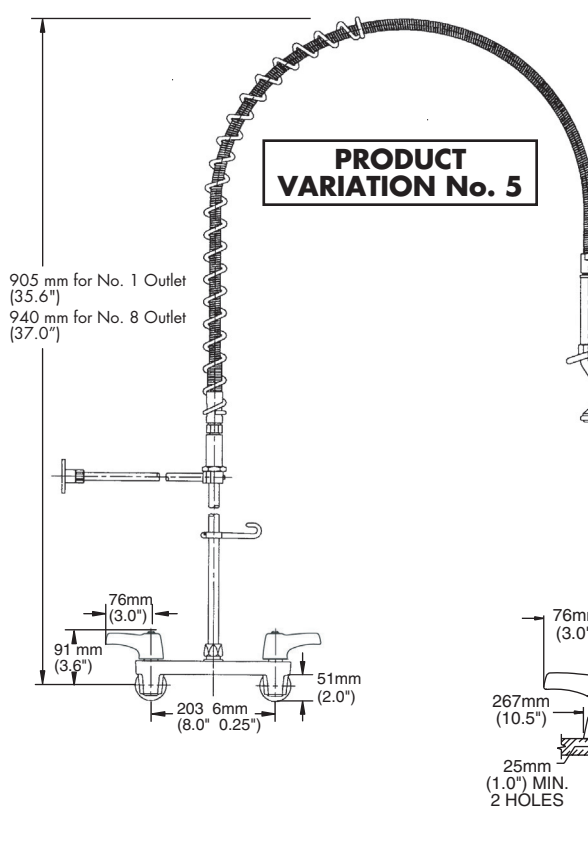

### Thin Wall Installation

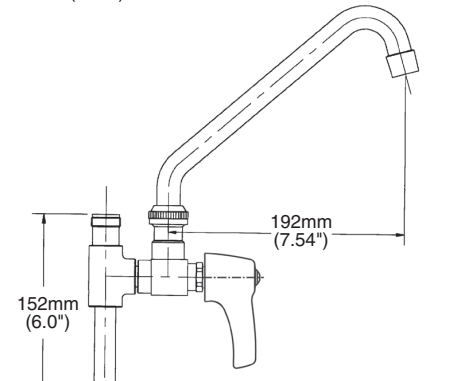
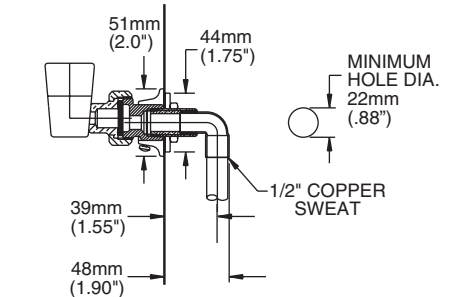

### PRODUCT VARIATION No. 3

Note: Overall Height  
 850mm (33.5") for No. 1 Outlet  
 885mm (34.9") for No. 8 Outlet

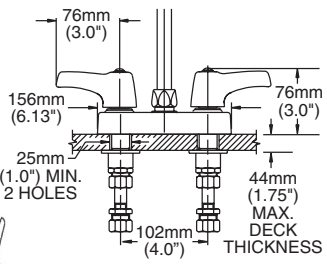

### PRODUCT VARIATION No. 2

Note: Overall Height  
 850mm (33.5") for No. 1 Outlet  
 885mm (34.9") for No. 8 Outlet

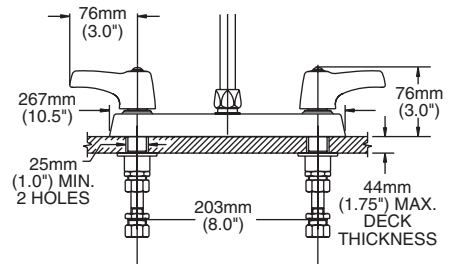

Note: Use this page front and back as a product submittal sheet.