



TO: AUTHORIZED *Portable Electric Tool* SERVICE STATIONS
After-Sales Service Regional Service Managers

DATE: June 2009

TOOL(S) \ PRODUCT(S) AFFECTED: 6230, 6230N TSC Deep Cut Band Saw
6236, 6236N AC/DC Deep Cut Band Saw

SUBJECT: INTERCHANGEABILITY of service replacement parts between the 6230 & 6230N TSC Deep Cut Band Saws, within serial number series 678E, 678F, 678G, 678H, 678J & C05A and 6236 & 6236N AC/DC Deep Cut Band Saws, within serial number series 769G & C06A

Catalog Number/Model	Serial Number SERIES	Service Parts List Bulletin
6230	678E	54-40-0279
6230	678F	54-40-0775
6230	678G	54-40-0776
6230	678H	54-40-0777
6230	678J	54-40-0778
6230N	C05A	54-40-6230
6236	769G	54-40-0288
6236N	C06A	54-40-6236

Attached pages show the service replacement parts which did not change between the recent model/catalog number change of Deep Cut Band Saws; additionally the pages offer those service replacement parts that are both **interchangeable** and **non-interchangeable** between models.

Service Replacement Parts that are **interchangeable** – are fully functional and work between models; however, it/they will change the appearance of the unit being serviced.

Please note – 42-28-0206 FRONT BLADE GUIDE BLOCK KIT and 42-28-0211 REAR BLADE GUIDE BLOCK KIT will fit the 6230N & 6236N Band Saws and can be substituted for 42-28-0395 & 42-28-0400 GUIDE BLOCK ASSEMBLIES respectively – note, installing a REAR GUIDE BLOCK KIT 42-28-0211 on a 6230N or 6236N eliminates the need for 10-24 X 1/2" Pan Head Screw that passes through the Bumper [42-38-0042] of the 6230/6236.

14-30-0590 6230N/6236N GEARCASE KIT will fit a 6230/6236 Band Saw updating the band saw with the thicker steel adjustable Bumper [42-38-0290] – new thicker Bumper by itself will not fit an existing 6230/6236 Band Saw Gear Case. Note – with update the band saw will no longer fit original carrying case.

Please refer to the appropriate Service Parts List Bulletins to compare and obtain the correct service replacement part number of the interchangeable spare part(s).

This bulletin is for informational purposes. PLEASE NOTE ON SERVICE PARTS LIST: 54-40-0279, 54-40-0288, 54-40-0775, 54-40-0776, 54-40-0777, 54-40-0778, 54-40-6230 and 54-40-6236

SPLB 54-40-0279 **678E**
SPLB 54-40-0775 **678F**
SPLB 54-40-0776 **678G**
SPLB 54-40-0777 **678H**
SPLB 54-40-0778 **678J**

6230 Bandsaw

- = no change - same part number
- = part changed - interchangeable
- = part changed - not interchangeable

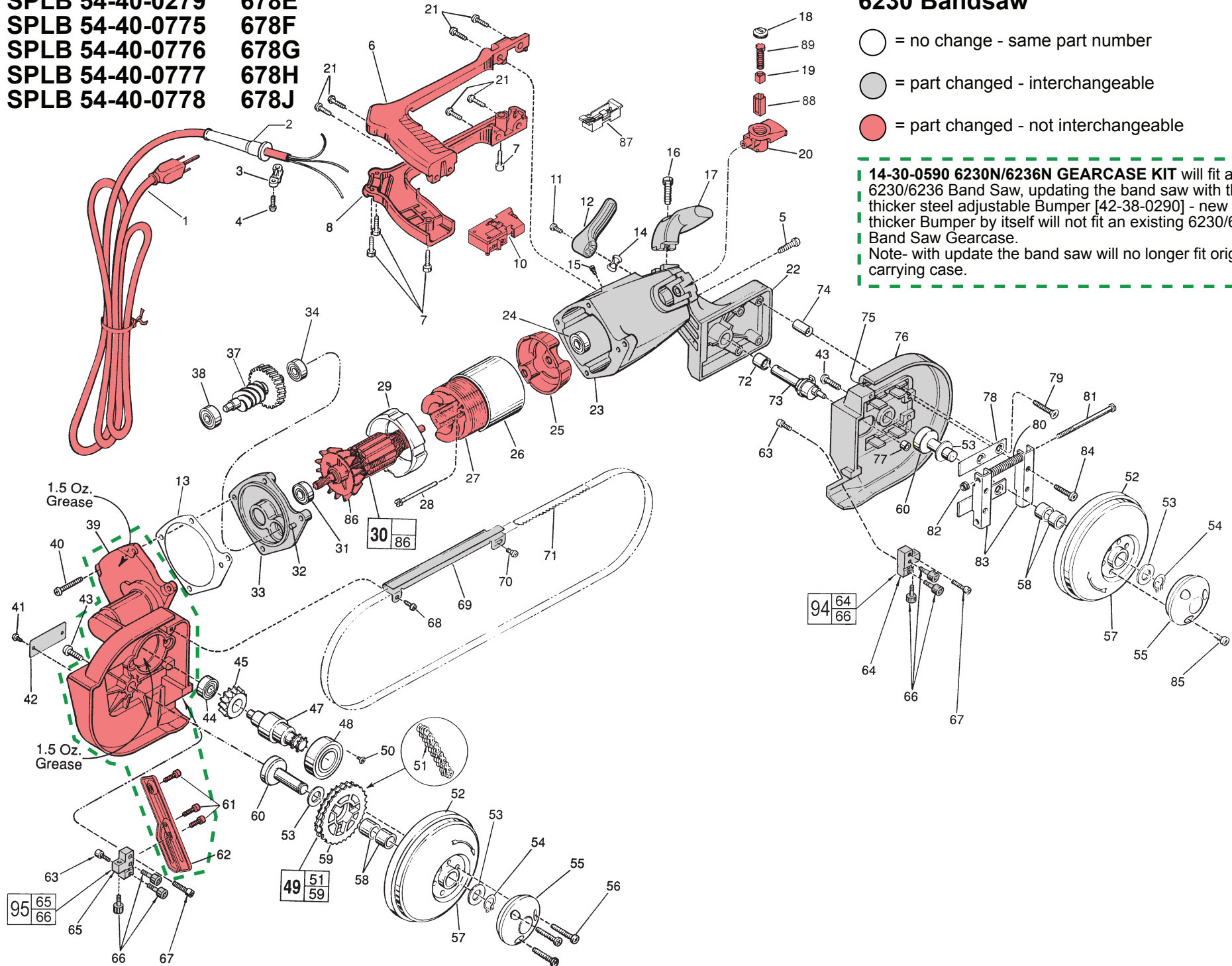

14-30-0590 6230N/6236N GEARCASE KIT will fit a 6230/6236 Band Saw, updating the band saw with the thicker steel adjustable Bumper [42-38-0290] - new thicker Bumper by itself will not fit an existing 6230/6236 Band Saw Gearcase.
 Note- with update the band saw will no longer fit original carrying case.

SPLB 54-40-6230 C05A

6230N Bandsaw

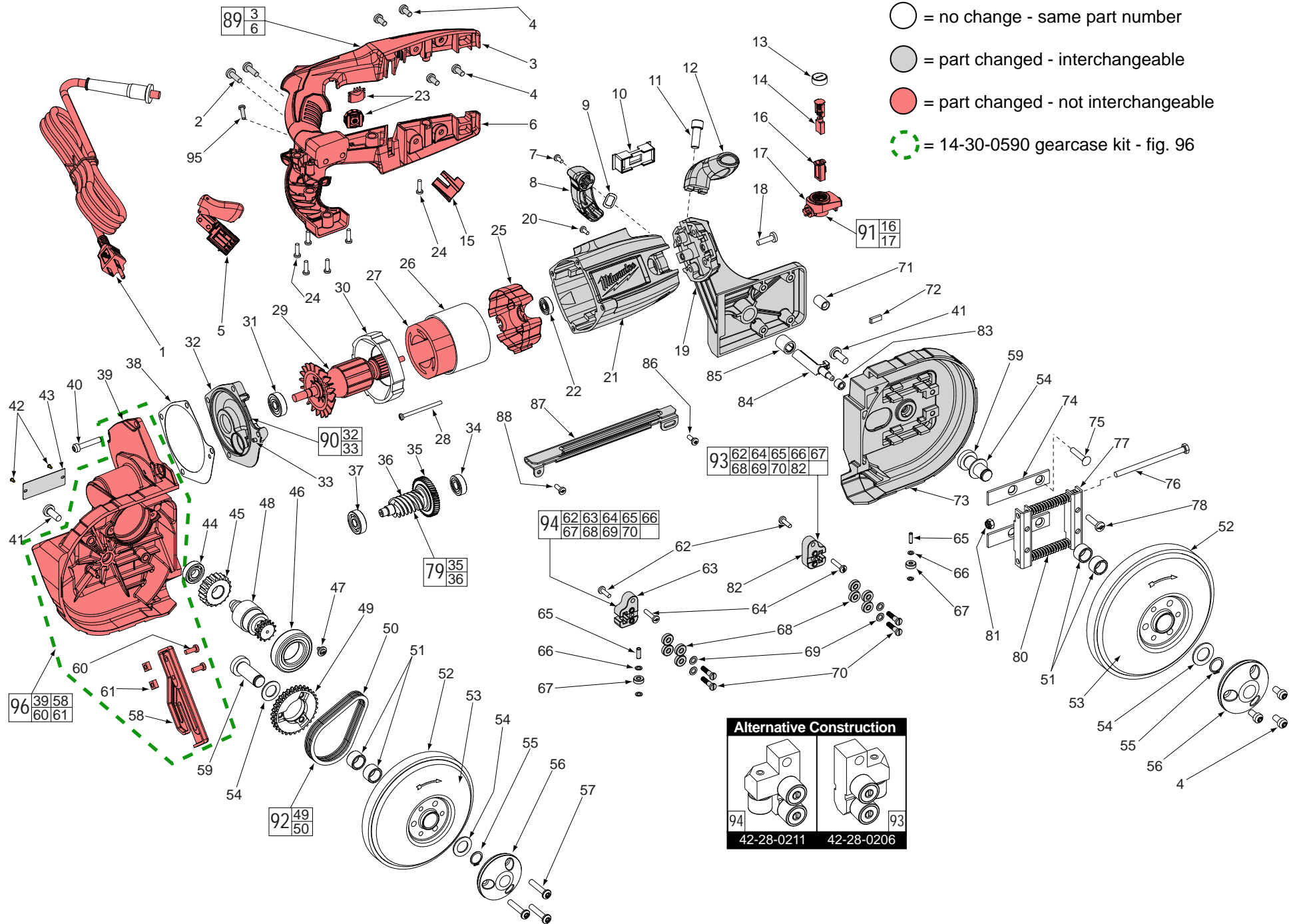

89 3/6

91 16/17

90 32/33

93 62 64 65 66 67
68 69 70 82

94 62 63 64 65 66
67 68 69 70

79 35/36

96 39 58
60 61

92 49/50

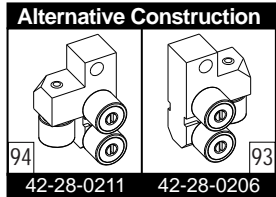

SPLB 54-40-0288 769G

6236 Bandsaw

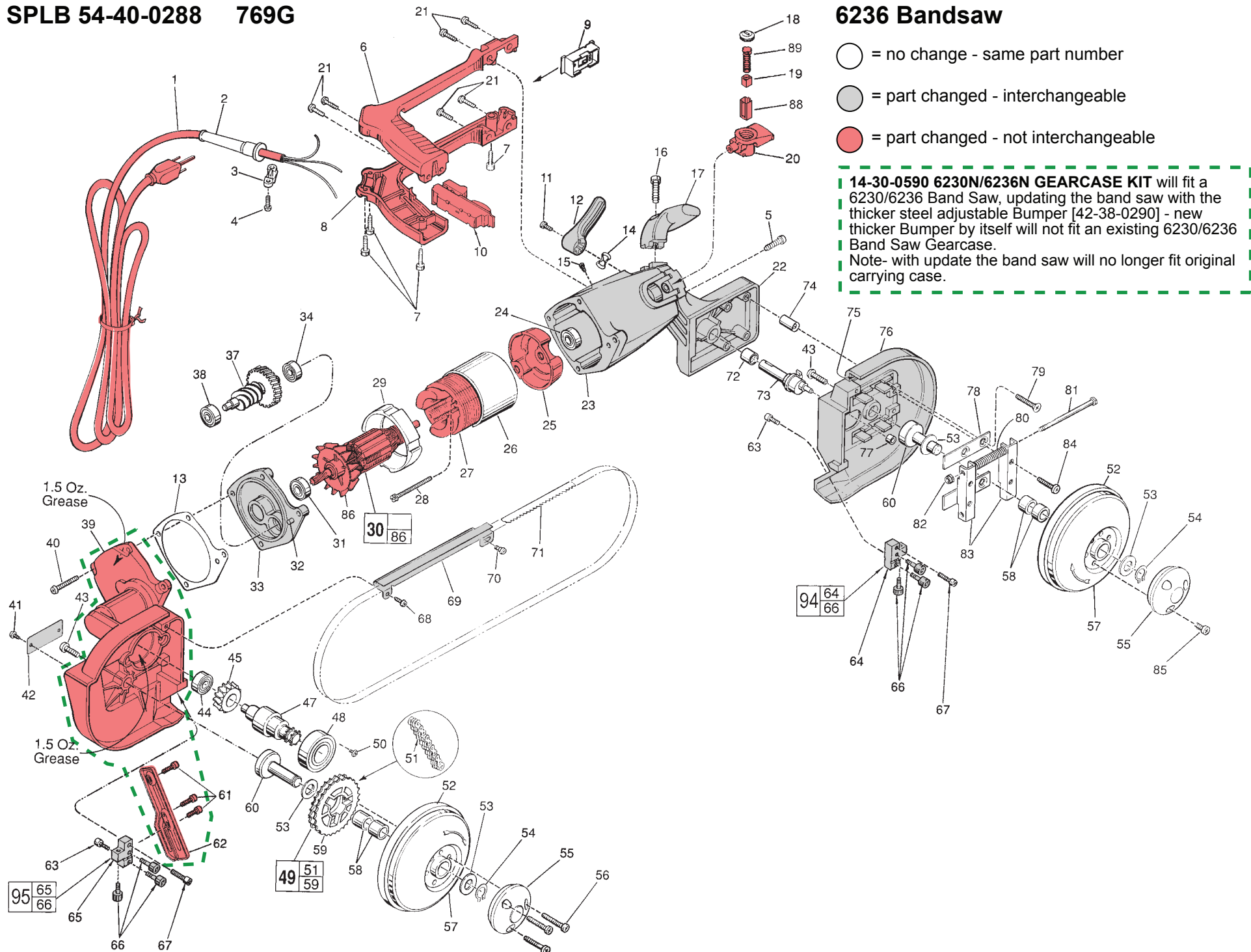

SPLB 54-40-6236 C06A

6236N Bandsaw

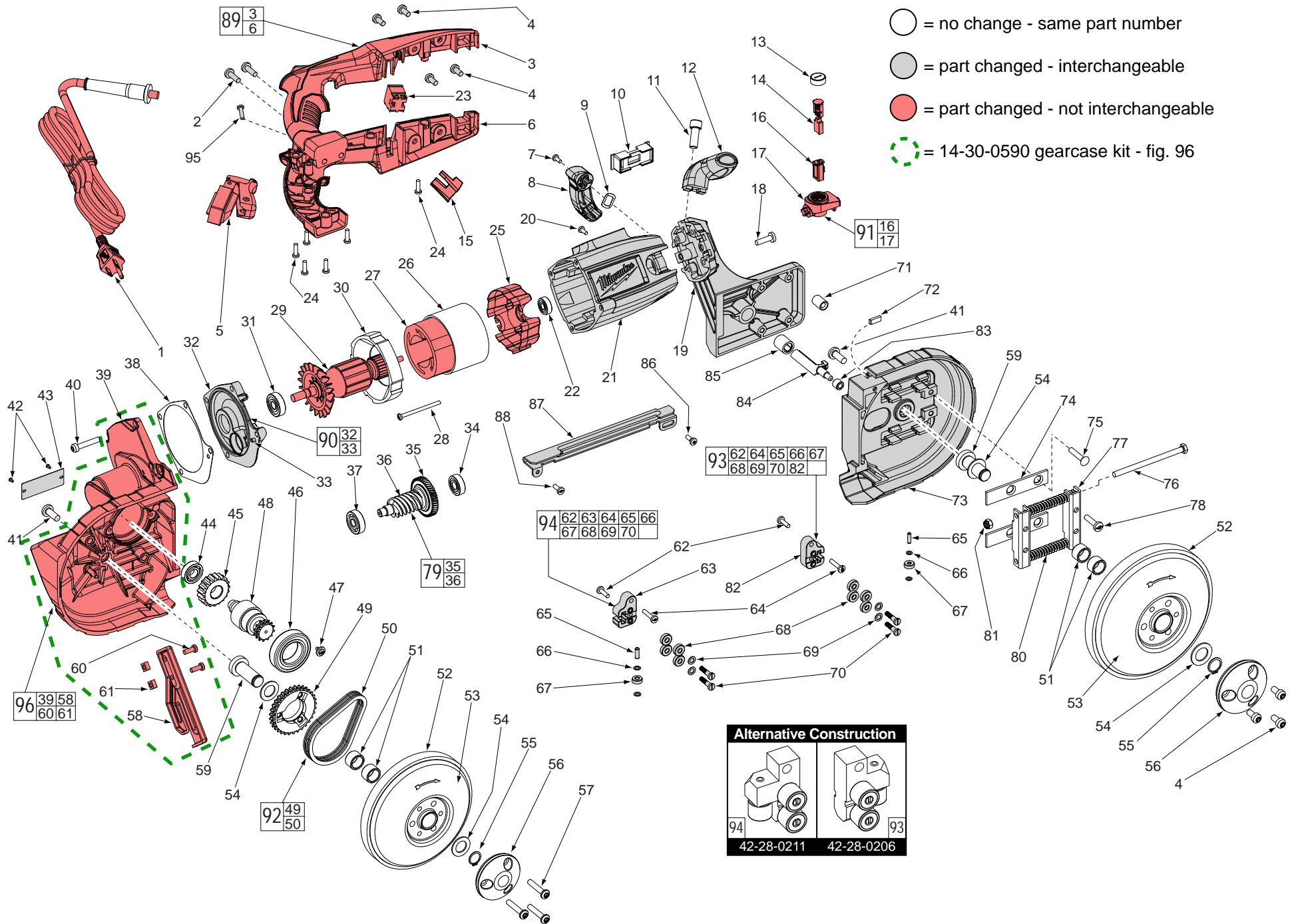

Alternative Construction

94 42-28-0211 93 42-28-0206