

WARRANTY

 Limited Lifetime – Residential
 Limited 25-year – Commercial

Manufactured from Swanstone solid surface
 (see page 2 for detailed information)

Recommended for high use traffic areas and commercial surfaces
FEATURES

- Reinforced solid surface means color and texture run all the way through and cannot wear away
- Renewable surface will not wear away
- Coordinates with Swanstone shower and bath systems
- Available in a variety of sizes and colors (see below)
- Easily accommodates all faucet styles
- Chemical resistant—acetone will not harm
- Heat resistant—hot curling irons will not burn
- Make-up and hair-dye can be buffed out with household cleansers
- Heat, stain and scratch resistant for lasting beauty

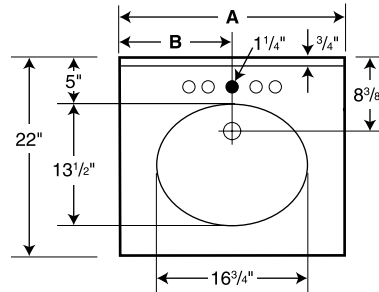

Model	A	B
VT1B2225	25"	12-1/2"
VT1B2231	31"	15-1/2"
VT1B2237	37"	18-1/2"
VT1B2243	43"	21-1/2"
VT1B2249	49"	24-1/2"
VT1B2255	55"	27-1/2"
VT1B2261	61"	30-1/2"

○ Drill Points ● Pre-drilled

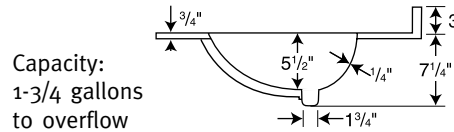
 Capacity:
 1-3/4 gallons
 to overflow

Available only in minimum quantities and limited colors
SPECIFICATIONS
Ellipse 22" Single Bowl Vanity Tops

Model	Part	Dimensions	Ship Wt. Lb.	Ship UPS	Carton Dims. In.	Cu. Ft.
VT1B2225	VT02225	22" D x 25" W	21	UPS	29 x 25 x 13	5.45
VT1B2231	VT02231	22" D x 31" W	26	UPS	35 x 25 x 13	6.58
VT1B2237	VT02237	22" D x 37" W	30	UPS	41 x 25 x 13	7.71
VT1B2243	VT02243	22" D x 43" W	31	UPS	46 x 25 x 13	8.65
VT1B2249	VT02249	22" D x 49" W	36	UPS	53 x 25 x 12	9.21
VT1B2255	VC02255	22" D x 55" W	55	-	58 x 25 x 13	10.91
VT1B2261	VC02261	22" D x 61" W	59	-	63 x 27 x 13	12.80

COLORS

(See inside back cover for color sample.)

- White (010)
- Bone (037)
- Bisque (018)
- Arctic Granite (035)
- Gray Granite (042)
- Tahiti Desert (050)
- Tahiti Ivory (059)
- Cornflower (063)

Kit Includes: One compression molded vanity top with overflow and integral bowl and back splash plus complete installation instructions.

Packaging: Each Swanstone unit is packed in a rectangular carton.

ACCESSORIES

- Optional VT21-3SS Side Splash available (see page 42)
- Optional Front and Side Apron available (see page 42)

STANDARDS AND RATINGS

Class 1A fire rating

American National Standard Institute—ANSI Z124.3

International Association of Plumbing and Mechanical Officials (IAPMO)—listed

cUPC listed—Certified to CSA Standard B45 by IAPMO

National Sanitation Foundation-NSF Splash Zone, -NSF Food Zone

American Society for Testing and Materials

National Electrical Manufacturers Association

For a complete list of tests and results see the Technical Data Sheet – page 131.

SUPPORT DOCUMENTS

 Installation instructions available on line at www.swanstone.com
 **MADE IN USA.**
MAINTENANCE AND CLEANING INFORMATION

 Cleaning regularly with liquid cleansers such as Dow or Lysol foaming bubbles is recommended. If necessary, Ajax, Comet, Soft Scrub, Bon Ami, Barkeeper's Friend and similar abrasive cleaners are safe and effective for use with a Scotch-Brite, Mr. Clean Magic Eraser or other similar pads and sponges. Lime-Away, Rust Out, Whink or other similar mineral-stain removers are acceptable as well. **Do not** use SOS, Brillo or other metal scouring pads.