



ENGINEERING EXCELLENCE

Prenza Series #6PR820

PARTS BREAKDOWN SHEET

DESCRIPTION

- Handheld Shower Set
- Metal Lever Handle
- Two Way Diverter Valve
- Deck or Ledge Mount
- Single Function Handheld Showerhead
- Anti-Backflow Device
- 60" Stainless Steel Flex Hose

FINISHES

- PC PVD Polished Chrome
- BN PVD Brushed Nickel
- SS PVD Stainless Steel
- PN PVD Polished Nickel



STANDARDS APPLICABLE

- ASME A112.18.1
- ANSI A117.1
- ADA COMPLIANT

FLOW

- Showerhead Limited to 2.5 GPM

#6PR820 SHOWN * ADA 

Model #: _____

Specific Features: _____

Project Name: _____

Submitted For: _____

Model	Description	Finishes	
#6PR820	Handheld Shower Set	<input type="checkbox"/> PC	<input type="checkbox"/> Other___



ENGINEERING EXCELLENCE

Pioneer: 1-800-338-9468
 Commerce, CA 90040
 www.pioneerind.com
 Pioneer Industries, Inc. © 2013

DMPB6PR820/REV. 12 2012
 Page 1 of 2

	ITEM#	DESCRIPTION
A	X-1400019*	Prenza Lever Handle
B	X-4400069	Handle Locknut
C	X-4900053	Stem Extension
D	X-4600037	Valve Mounting Kit
E	X-3600004	Ceramic Stem Assembly
F	X-4900077	Mounting Tool
G	X-4600023	Spout Adapter
H	X-4600041	Check Valve
I	X-4600006*	60" Stainless Steel Flex Hose
J	X-5600004	Mounting Kit
K	X-4600042*	Showerhead Holder
L	X-4600043*	Handheld Showerhead

* Note- Please specify finish/color code while ordering.

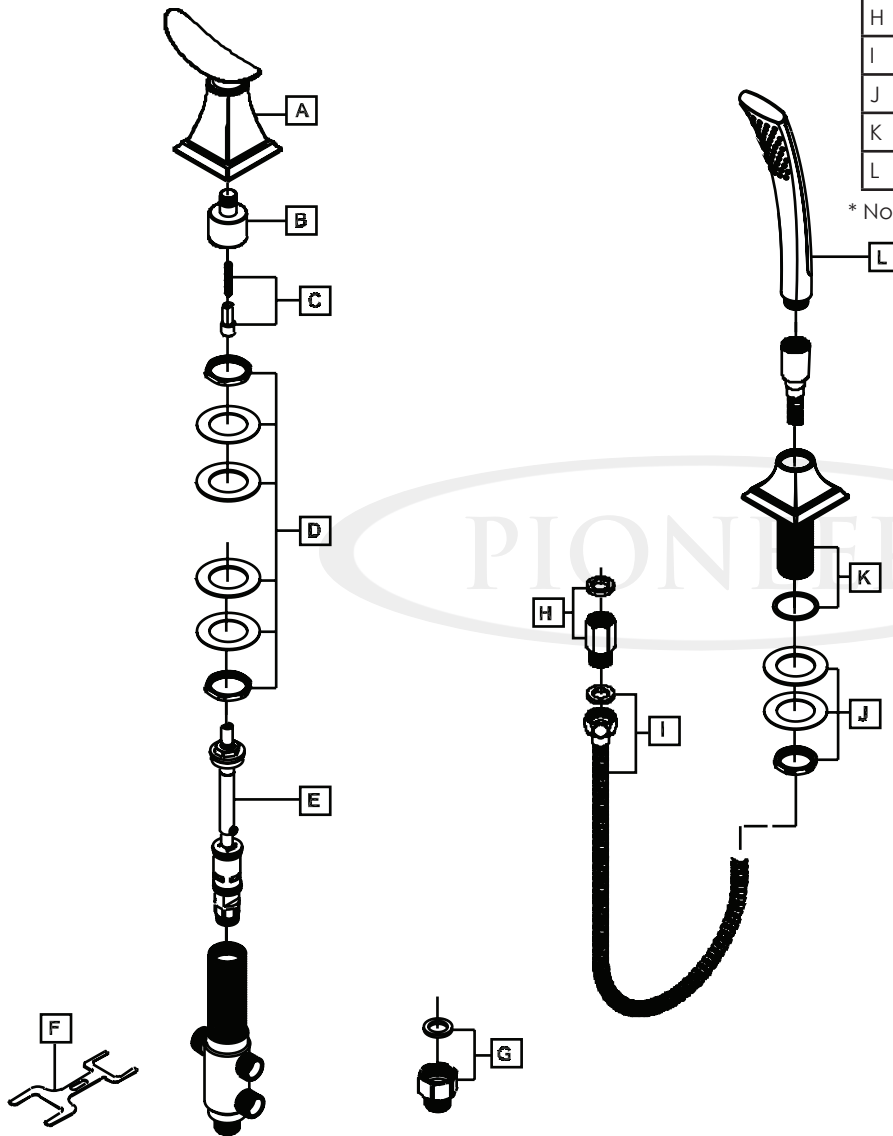

Product Diagram



ENGINEERING EXCELLENCE

Pioneer: 1-800-338-9468
 Commerce, CA 90040
 www.pioneerind.com
 Pioneer Industries, Inc. © 2013