



ENGINEERING EXCELLENCE

Motegi Series #4MT611

PARTS BREAKDOWN SHEET

DESCRIPTION

- Two Handle Roman Tub Set With Handheld Showerhead
- Metal Lever Handles
- Rigid Bent Nose Spout
- 9-3/8" Reach
- Ceramic Disc Cartridges
- 4-Hole 8" to 16" Installation
- Includes Integral Diverter Valve
- Single Function Handheld Showerhead

FINISHES

- PC PVD Polished Chrome
- BN PVD Brushed Nickel
- SS PVD Stainless Steel
- PN PVD Polished Nickel
- PB PVD Polished Brass



#4MT611 SHOWN * ADA 

Note:-

Rough-in valve included.

STANDARDS APPLICABLE

- ASME A112.18.1
- ANSI A117.1
- CUPC / IAPMO LISTED / ADA COMPLIANT

FLOW

- Showerhead Limited to 2.5 GPM

Model #: _____

Specific Features: _____

Project Name: _____

Submitted For: _____

Model	Description	Finishes	
#4MT611	Two Handle Roman Tub Set With Handheld Showerhead	<input type="checkbox"/> PC	<input type="checkbox"/> Other__



ENGINEERING EXCELLENCE

Pioneer:1-800-338-9468
 Commerce, CA 90040
 www.pioneerind.com
 Pioneer Industries, Inc. © 2013

DMPB4MT611/REV. 12 2012
 Page 1 of 2

	ITEM#	DESCRIPTION
A	X-4900049*	Handheld Showerhead
B	X-4900051*	Handheld Showerhead Support
C	X-5900003	Handheld Showerhead Mounting Kit
D	X-4600006*	60" Stainless Steel Hose
E	X-4900024	3/32" Allen Wrench
F	X-1400006*	Motegi Series Handle
G	X-4400039*	Valve Escutcheon
H	X-5400003	Valve Mounting Kit
I	X-4900022	Bonnet Nut
J	X-3900002C,H	Ceramic Cartridge-Cold,Hot
K	X-4900004	Supply Nut
L	X-4400063	Connector Hose
M	X-3400004	Diverter Assembly
N	X-2400008*	Motegi Bent Nose Spout
1	X-4900050	Handheld Showerhead O-ring
2	X-4900047	Washer
3	X-4900044*	Hole Cover
4	X-4900002	3/32" Allen Screw
5	X-4400038	Handle Adapter Set
6	X-4400036*	Flow Streamer
7	X-4400037*	Diverter Pull Rod
8	X-4900044*	Hole cover
9	X-4400024	3/32" Allen Screw
10	X-4400035*	Spout Escutcheon

* Note: Please specify finish/color when ordering.

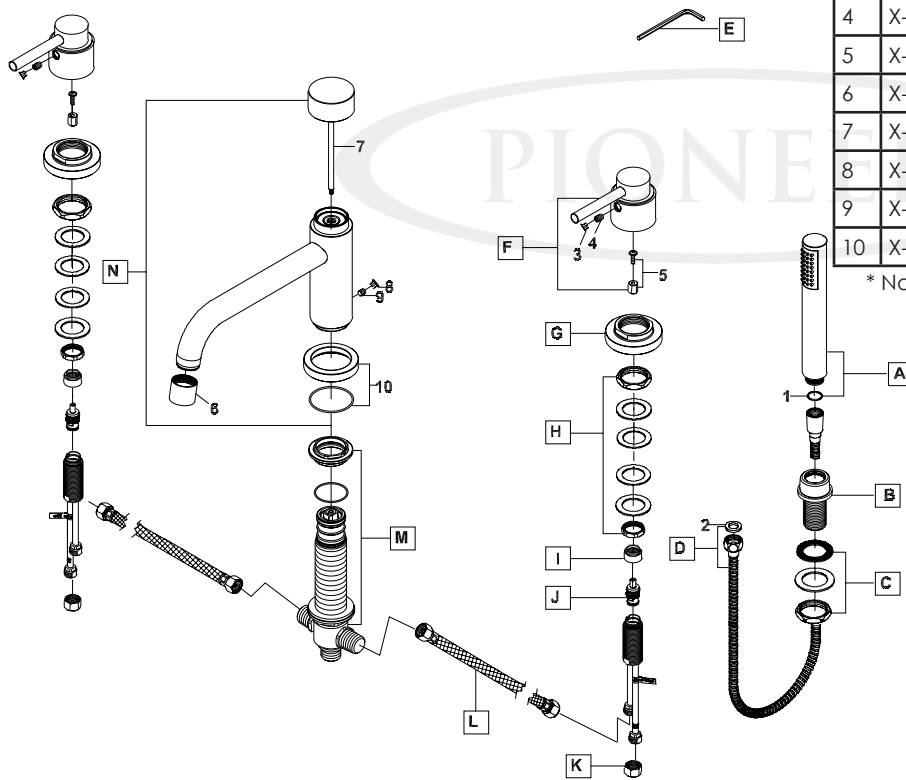

Product Diagram



ENGINEERING EXCELLENCE

Pioneer:1-800-338-9468
 Commerce, CA 90040
 www.pioneerind.com
 Pioneer Industries, Inc. © 2013