



ENGINEERING EXCELLENCE

Installation Guide

Single Handle Diverter Trim Set:

- 6LG101T*
- 6DM101T*
- 6CB101T*
- 6PR101T*
- 6AM101T*
- 6BR101T*
- 6BR111T*
- 6BR121T
- 6BR131T*
- 6MT101T*
- 6CS101T*
- 6GB101T*
- 6BL101T*

This product meets the following standards:

- ASME A112.18.1
- CUPC / IAPMO LISTED / *ADA COMPLIANT



Thank you for purchasing this pioneer quality product.

Tools Required

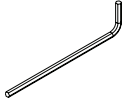
				
Plumbers Putty	3/32" Allen Wrench			

Prior to Installation

- Observe all local plumbing and building codes before you begin installation.
- The finished wall or Diverter Valve (4100B) must be installed prior to installing this trim.
- Pioneer reserves the right to make changes in the design of faucets without notice as specified in the pricebook.

Trim Installation

1. Remove the protective cover if placed on the valve.
 2. Thread the valve sleeve (A) on the valve. Install the handle adapter (B) on the diverter valve stem. secure the handle adapter (B) with the screw.
 3. Slide the face plate (C) on the valve sleeve. Ensure the rubber gasket is behind the face plate (C). If necessary apply silicon to caulk around the face plate (C) to form water tight seal.
 4. Install the handle (D) on the handle adapter (B). Tighten the allen screw (E) with 3/32" size allen wrench.
- Check if water diverts to desired outlet.

1

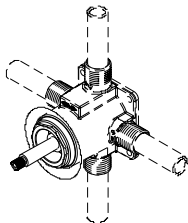

2

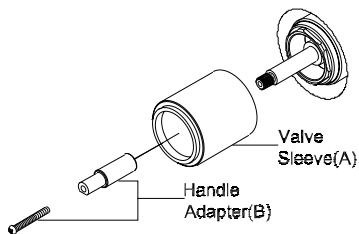

3

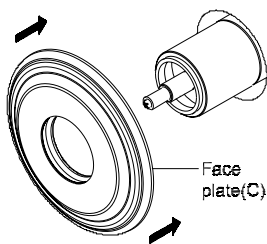

4

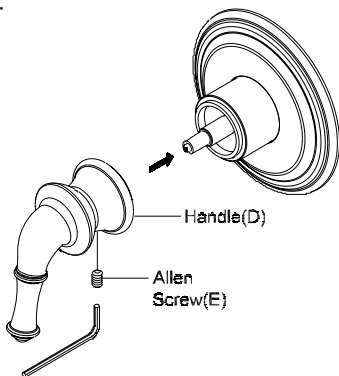

For more care information or trouble shooting inquiries about your Pioneer Product, please see the contact information on the back page.



ENGINEERING EXCELLENCE

3325 S. Garfield Ave. | Commerce, CA 90040
Telephone: (800) 338-9468 | (323) 888-8873 | Fax: (323) 888-9515
Hours: M - F, 7:30am to 5:00pm PST
www.pioneerind.com