



ENGINEERING EXCELLENCE

Legacy Series #2LG120

PARTS BREAKDOWN SHEET

DESCRIPTION

- Two Handle Kitchen Faucet
- ADA Wrist Blade Handles
- Spout Swivel 360°
- 9-11/16" Reach, 5-1/4" From Deck to Aerator
- Ceramic Disc Cartridges
- 3-Hole 8" Installation

FINISHES

- PC PVD Polished Chrome



#2LG120 SHOWN * ADA 

STANDARDS APPLICABLE

- ASME A112.18.1
- ANSI A117.1
- ANSI / NSF 61, SECTION 9
- CUPC / IAPMO LISTED / ADA COMPLIANT
- CONTAINS NO MORE THAN 0.25% WEIGHTED AVERAGE LEAD CONTENT

FLOW

- Aerator Limited to 1.5 GPM

Model #: _____

Specific Features: _____

Project Name: _____

Submitted For: _____

Model	Description	Finishes	
#2LG120	Two Handle Kitchen Faucet	<input type="checkbox"/> PC	<input type="checkbox"/> Other__



ENGINEERING EXCELLENCE

Pioneer: 1-800-338-9468
 Commerce, CA 90040
 www.pioneerind.com
 Pioneer Industries, Inc. © 2013

DMPB2LG120/REV. 12 2012

Page 1 of 2

ITEM#	DESCRIPTION
A	X-1900003C,H ADA Wrist Blade Handle- Cold, Hot
B	X-4900007 Bonnet Nut
C	X-4200014 Deck Plate
D	X-3900002C Ceramic Stem - Cold
E	X-3900002H Ceramic Stem - Hot
F	X-4200015 Base Plate
G	X-4900008 Mounting Kit
H	X-4900004 Supply Nut
I	X-4200058 Cap
J	X-4200011 Retainer Nut & Washer
K	X-2200002 Legacy Spout
L	X-4200012 Spout O-Ring
M	X-4200013 Spout Gasket
1	X-4900010 ADA Wrist Blade Handle Screw
2	X-4900011C,H Handle Index-Cold & Hot
3	X-4900081 1.5 GPM Aerator

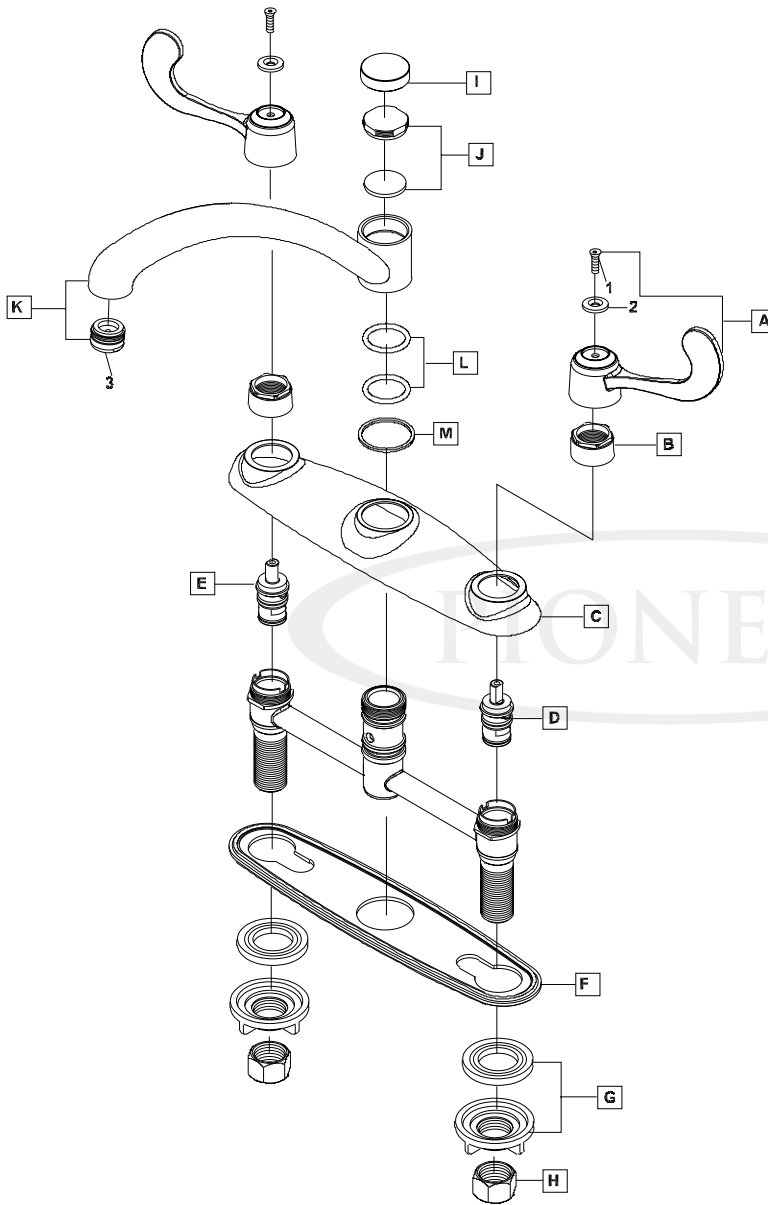

Product Diagram



ENGINEERING EXCELLENCE

Pioneer: 1-800-338-9468
 Commerce, CA 90040
 www.pioneerind.com
 Pioneer Industries, Inc. © 2013