

Little GIANT®

DOUBLE-FLOAT MECHANICAL SWITCH

FOR USE WITH SUMP, SEWAGE AND EFFLUENT PUMPS



Applications

- Small or large sumps
- Holding tanks
- Conversion of non-automatic pumps
- Replacement for diaphragm or probe type controls

Features

- Reliable, independently-mounted switch greatly reduces drudgery of automatic pump repair
- Unique electrical circuit designed for long life
- Totally self-contained pump switch — no control panel required
- Directly switches pumps with high starting currents
- Sealed, water and weather resistant
- Adjustable pump range — 10" to 56" maximum
- May be used with small or large pump chambers
- Less sensitive to turbulence
- Entire unit (control as well as cord set) is UR component recognized and CSA certified

Specifications

- Non-corrosive plastic float for use in liquids up to 140°F (60°C)
- Flexible 16 gauge, 2 conductor, SJOW, water-resistant cable from float to splice. 14 gauge, 3 conductor, SJTW thermoplastic, water-resistant cord

The float switches are a heavy-duty mechanical type with a unique circuit to help prevent relay contact arcing when starting or stopping the pump. The float switch consists of two floats (“on” and “off”) and two reusable mounting straps. Each sealed float contains a heavy-duty switch with a holding relay sealed inside the splice tube.

Specifications

Item Number	Model Number	Volts	Hz.	Phase	Maximum Starting Amps	Maximum Run Amps	Maximum HP
14940410	15DFMMD1WP	115	60	1	78	13	1
14940411	15DFMMDWOP	230	60	1	78	13	2

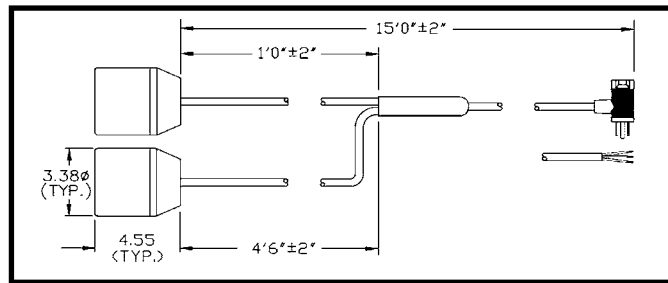

General Installation Instructions

WARNING: Turn off power source before installing or adjusting this device. Failure to turn off power could result in serious or fatal electrical shock.

1. Decide the pumping range for your installation (see Figure A). The distance between the float straps is the pumping range. Securely strap the final cables to the discharge pipe for the pump range you desire. NOTE: The gray float must be the top float.
2. Insert 120V piggy-back plug into 120V outlet. To avoid electrical hazards and corrosion problems, the electrical outlet must not be located in pump chamber.
3. Plug pump directly into piggy-back plug (see Figure B).
4. Allow the pump to cycle once to check your installation. Float straps are reusable, which permits readjustment.
5. For direct wire installation (without piggy-back). (See Figure C.)

NOTE: Connect 120V Double Float controls to 120 Volts only.
Connect 230V Double Float controls to 230 Volts only.
If wired to incorrect voltage, control will malfunction.

WARNING - 230V INSTALLATIONS: In a 230V pump installation, one side of the line going to the pump is always "hot". This condition exists regardless of whether the float switch is "on" or "off". To avoid hazards when installing or servicing, install a double-pole disconnect switch near pump installation.

NOTE: Little Giant Pump Co. cannot be responsible for damages caused by faulty or negligent installation of this control. If you feel that you may encounter problems in installing this device, we respectfully suggest you engage the services of a competent plumber, electrician, or service person.

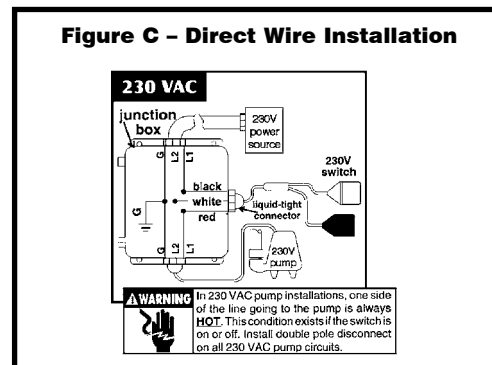
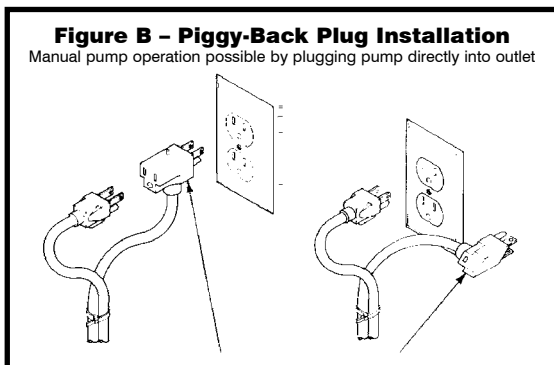
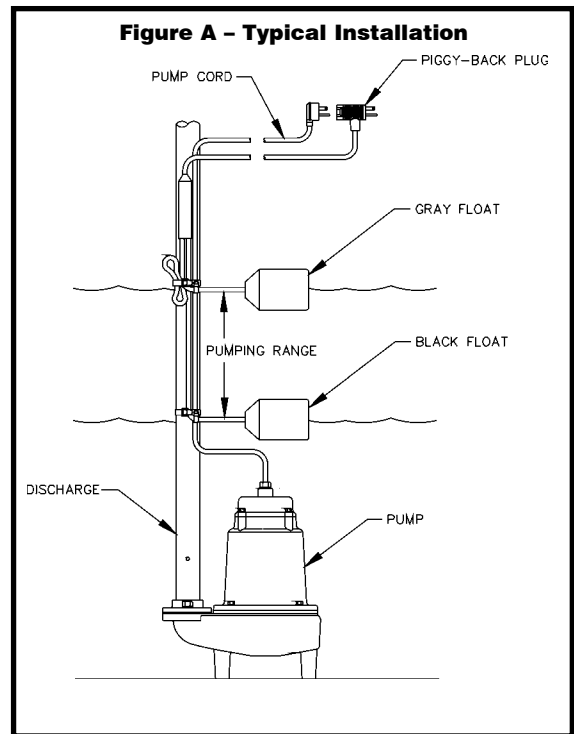

Little GIANT
 PO Box 12010 • Oklahoma City, OK 73157
 Phone: 800.701.7894 • Fax: 800.701.8046
 E-mail: customerservice@littlegiant.com