

CHICAGO FAUCETS
a Geberit company

2100 South Clearwater Drive
Des Plaines, IL 60018
Phone: 847-803-5000
Fax: 847-803-5454
www.chicagofaucets.com

REPAIR PARTS

FITTING NO.

927-XKCP

SUBMITTED MODEL NO.

ITEM NO.

BY: SID

DATE: 11-17-05

CHK: *[Signature]*

REV: 04-16-09

FOR TECHNICAL ASSISTANCE
1-800-TEC-TRUE (1-800-832-8783)

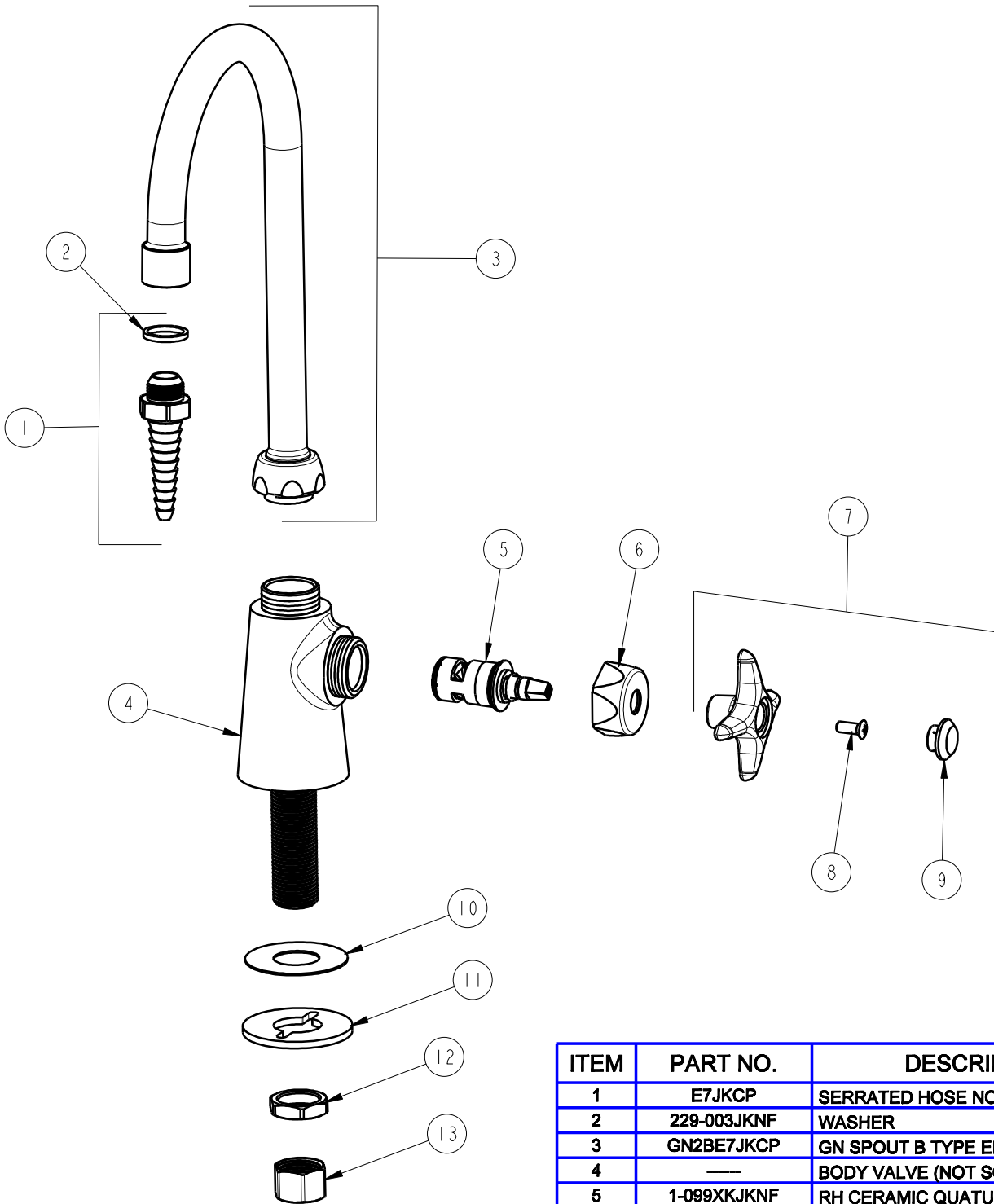

ITEM	PART NO.	DESCRIPTION
1	E7JKCP	SERRATED HOSE NOZZLE
2	229-003JKNF	WASHER
3	GN2BE7JKCP	GN SPOUT B TYPE END
4	---	BODY VALVE (NOT SOLD SEPARATELY)
5	1-099XKJKNF	RH CERAMIC QUATURN UNIT
6	444-005JKCP	CAP
7	204-CWJKCP	HANDLE ASSEMBLY
8	420-010JKRCF	SCREW, 10-32 UNC PH 1/2
9	216-178JKNF	BUTTON 'CW'
10	52-007JKNF	WASHER, RUBBER
11	807-112JKNF	WASHER
12	49-004JKRBF	LOCKNUT
13	49-005JKRBF	COUPLING NUT