

CHICAGO FAUCETS
 a Geberit company

2100 South Clearwater Drive
 Des Plaines, IL 60018
 Phone: 847-803-5000
 Fax: 847-803-5454
 www.chicagofaucets.com

REPAIR PARTS

FITTING NO.

629-E36ABCP

SUBMITTED MODEL NO.

BY: JAR DATE: 09-20-11

CHK: *JAR* REV:

ITEM NO.

FOR TECHNICAL ASSISTANCE
 1-800-TEC-TRUE (1-800-832-8783)

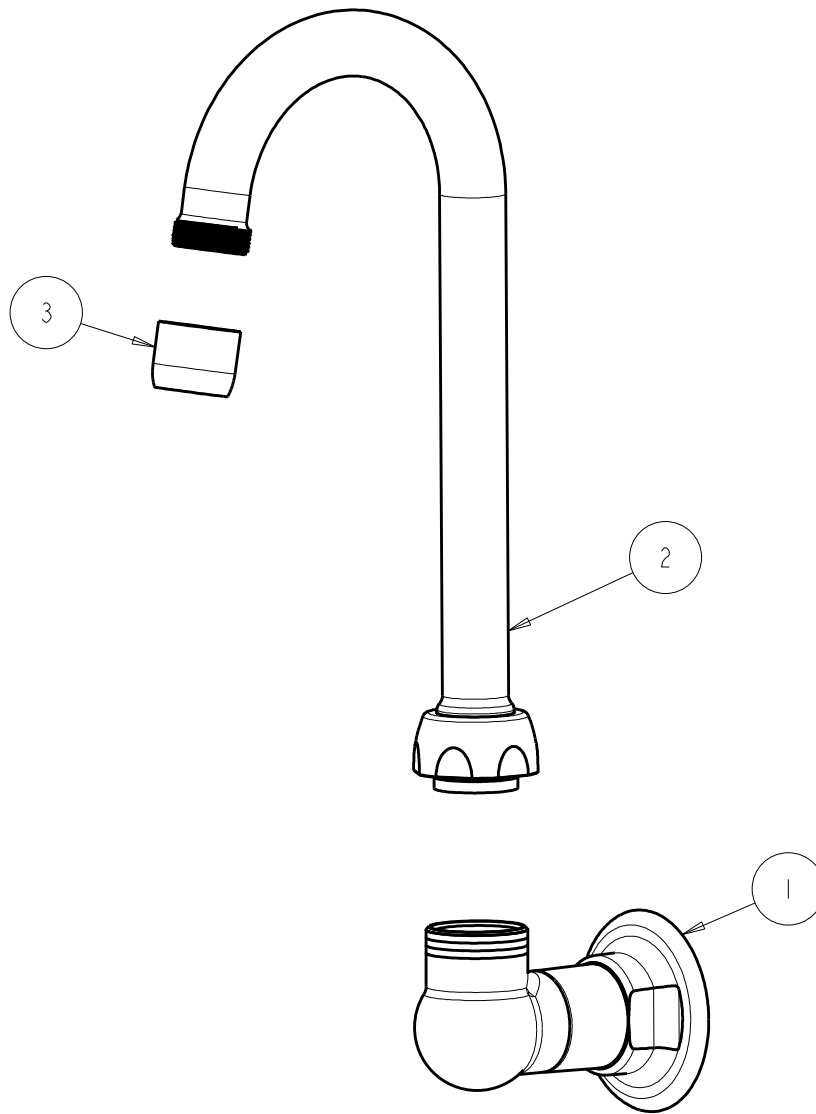

ITEM	PART NO.	DESCRIPTION
1	629-LESSSPTCP	SINGLE WATER INLET FITTING
2	GN1AJKABCP	FOR PARTS SEE GN1AJKABCP
3	E36JKCP	OUTLET, 1.5 GPM LAMINAR