

**CHICAGO FAUCETS**  
a Geberit company

2100 South Clearwater Drive  
Des Plaines, IL 60018  
Phone: 847-803-5000  
Fax: 847-803-5454  
www.chicagofaucets.com

# REPAIR PARTS

BY: JAR      DATE: 01-25-13  
CHK:          REV:

FITTING NO.  
**509-SSVBL12ABCP**

SUBMITTED MODEL NO.

ITEM NO.

**FOR TECHNICAL ASSISTANCE**  
1-800-TEC-TRUE (1-800-832-8783)

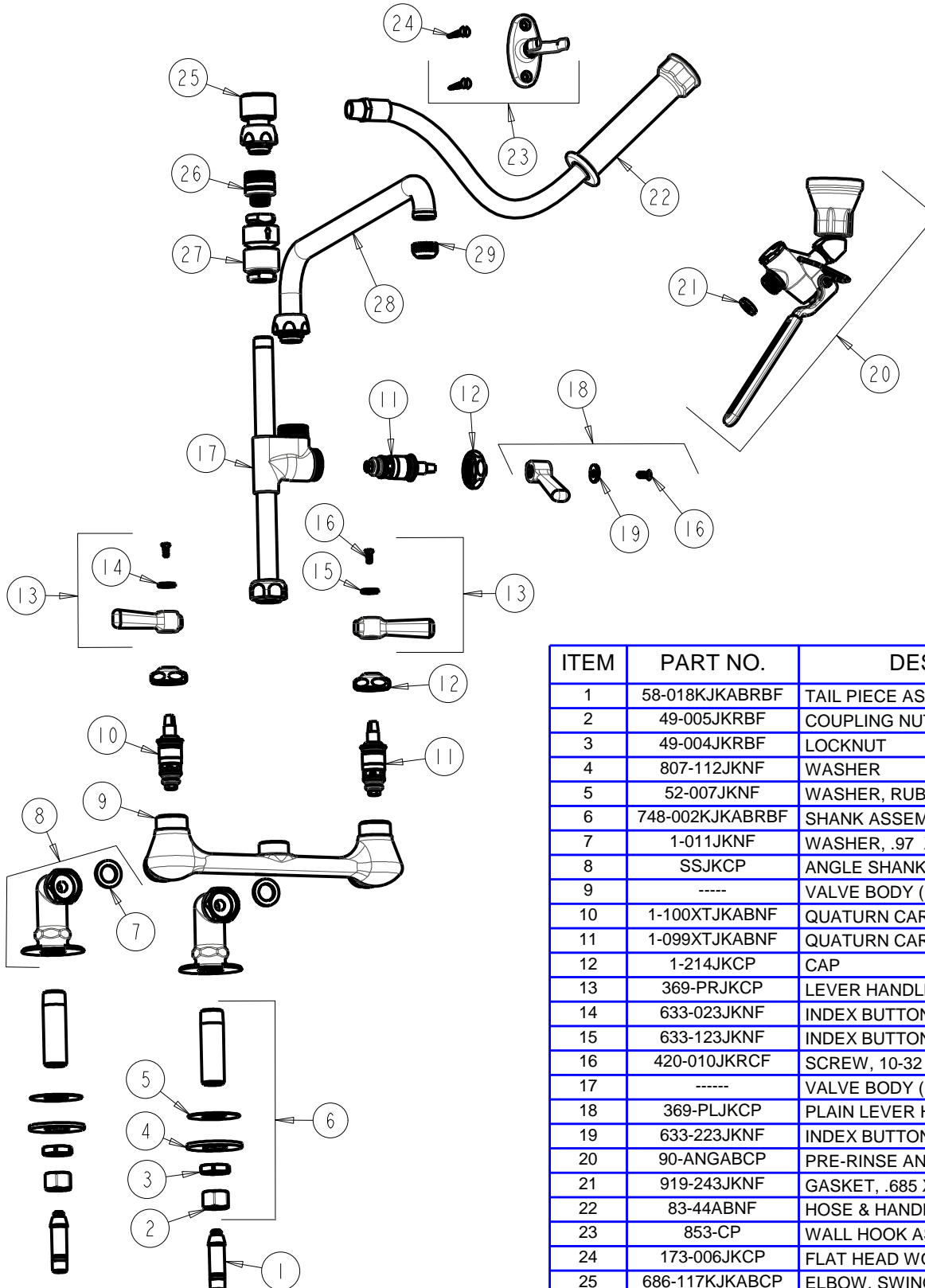

| ITEM | PART NO.        | DESCRIPTION                      |
|------|-----------------|----------------------------------|
| 1    | 58-018KJKABRBF  | TAIL PIECE ASSEMBLY              |
| 2    | 49-005JKRBF     | COUPLING NUT                     |
| 3    | 49-004JKRBF     | LOCKNUT                          |
| 4    | 807-112JKNF     | WASHER                           |
| 5    | 52-007JKNF      | WASHER, RUBBER                   |
| 6    | 748-002KJKABRBF | SHANK ASSEMBLY                   |
| 7    | 1-011JKNF       | WASHER, .97 X .62 X .12          |
| 8    | SSJKCP          | ANGLE SHANK ASEMBLY w/ WASHER    |
| 9    | -----           | VALVE BODY (NOT SOLD SEPARATELY) |
| 10   | 1-100XTJKABNF   | QUATURN CARTRIDGE (LH)           |
| 11   | 1-099XTJKABNF   | QUATURN CARTRIDGE (RH)           |
| 12   | 1-214JKCP       | CAP                              |
| 13   | 369-PRJKCP      | LEVER HANDLE ASSEMBLY (PAIR)     |
| 14   | 633-023JKNF     | INDEX BUTTON (RED)               |
| 15   | 633-123JKNF     | INDEX BUTTON (BLUE)              |
| 16   | 420-010JKRCF    | SCREW, 10-32 UNC PH 1/2          |
| 17   | -----           | VALVE BODY (NOT SOLD SEPARATELY) |
| 18   | 369-PLJKCP      | PLAIN LEVER HANDLE               |
| 19   | 633-223JKNF     | INDEX BUTTON (WHITE)             |
| 20   | 90-ANGABCP      | PRE-RINSE ANGLE VALVE LOW FLOW   |
| 21   | 919-243JKNF     | GASKET, .685 X .375 X .125       |
| 22   | 83-44ABNF       | HOSE & HANDLE 44"                |
| 23   | 853-CP          | WALL HOOK ASSEMBLY               |
| 24   | 173-006JKCP     | FLAT HEAD WOOD SCREW             |
| 25   | 686-117KJKABCP  | ELBOW, SWING ASSEMBLY            |
| 26   | 225-005JKCP     | ADAPTER                          |
| 27   | SP3524KJKABCP   | BACK-FLO PREVENTER               |
| 28   | L12LESSE3JKCP   | SPOUT                            |
| 29   | E1JKABRCF       | QUIXTOP OUTLET                   |